

Charnwood





BRITISH MADE STOVES SINCE 1972

It was in 1972 when, along with my father and older brother, we set up a small engineering business in Niton on the Isle of Wight. In those days we ran a repair shop and fabricated balustrades, gates and even hotel fire escapes. In the mid seventies Dutch Elm Disease ravaged the country killing an estimated 25 million trees. Simultaneously a hike in oil prices caused the cost of heating to escalate. These two factors combined to kick start the market for woodburning stoves in the UK. We saw a need for a small model for the local market so we fabricated our first stove *The Beacon*. Persuaded to exhibit at a specialist stove show in Welwyn we received orders from all over the UK which established us as a serious

stove manufacturer. Today selling under the brand name Charnwood, to many countries worldwide, employing 170 staff including second and third generation family, we manufacture stoves that exceed the highest standards set for efficiency and emissions. In our 50 plus years we have learnt three things that are vital to us:

- *Faith in God*
- *Make products we can believe in*
- *Value the people we work with, our customers and suppliers*

Take any one of those away and we wouldn't have made it!

John Wells • Founder of A.J Wells & Sons Ltd.



INTRO

INTRODUCTION	4
CLEAN BURN HEATING	6

STOVES

INTELLIGENT STOVES	10
SKYE E700	12
AIRE 300	14
AIRE 400	16
AIRE 500	18
AIRE 700	20
HAVEN	22
CRANMORE	26
CRANMORE 3	28
CRANMORE 5	30
CRANMORE INSERT	32
CRANMORE 7	34
AIRE	36
AIRE 3	38
AIRE 4	40
AIRE 5	42
AIRE 7	44
SKYE	46
SKYE 5	48
SKYE 7	50
ARC	52
ARC 5	54
ARC 7	56
COVE	58
COVE 2	60
COVE 3	62
ISLAND	64
ISLAND I	66
ISLAND II	68
ISLAND III	70

STOVES

BAY	72
BAY VL	74
BAY BX	76
C-SERIES	78
C-FOUR	80
C-FOUR INSERT	82
C-FIVE	84
C-SIX	86
C-SEVEN	88
C-EIGHT	90
THE BEMBRIDGE	92
COUNTRY 4	94

INNOVATION

CONVERTING GRATE	98
DROP-IN GRATE	98
QUATTROFLOW® SYSTEM	98
CHARNWOOD FLUE	98
HEAT SHIELDS	99
DROP-DOWN THROAT PLATE	99
FLUE BOILER	99
VERTICAL REAR FLUE ADAPTOR	99
EXTERNAL AIR KITS	99
COOKING PLATE	99
STOVE POD	100
COLOUR	102
STOVE SELECTOR	104
COMPARISON CHART	105
CHARNWOOD FIRESIDE	106

SPECIFICATIONS

AIRE	110
CRANMORE	113
ARC	114
ISLAND	114
COVE	115
BAY	116
C-SERIES	116
SKYE	118
HAVEN	119
THE BEMBRIDGE	119
COUNTRY 4	119
STOVE POD	119

FIRESIDE ACCESSORIES

ACCESSORIES	122
MOISTURE METER	122
ASH-CARRIER	122
STOVE PIPE THERMOMETER	122
TOASTING FORK	122
FIRE BALL	122
BODJ FAIR TRADE	124



FOLLOW @CHARNWOODSTOVES





EXCEPTIONAL BRITISH MADE STOVES

CHARNWOOD is a privately owned family business based on the Isle of Wight. Established in 1972 we have become one of the foremost stove companies in Europe specialising in the manufacture of fine fires and stoves. As a company we believe in taking a strong ethical approach to every area of our business; whether it be in how we design and build our stoves, how we treat our customers or the impact our products have on the environment.

Our stoves are designed and built to last. Even fifty years after manufacturing our first stove there are still many of our original models giving good service as they continue to heat peoples' homes. We believe that this is how it should be; an investment in a Charnwood is more than just a short term relationship.

Our company ethos includes buying, where possible, from local UK based suppliers. Our stoves are designed, and built in our factory here on the Isle of Wight and are manufactured using a combination of high-tech precision machinery and skilled hand work. We have employees who have been with us for well over 40 years and have seen the company grow from an operation producing a few hundred stoves a year to one making tens of thousands of units that are sold worldwide. Affirming this achievement, we were awarded The Queen's Award For Enterprise: International Trade in 2009 and The King's Award For Enterprise: International Trade in 2024.

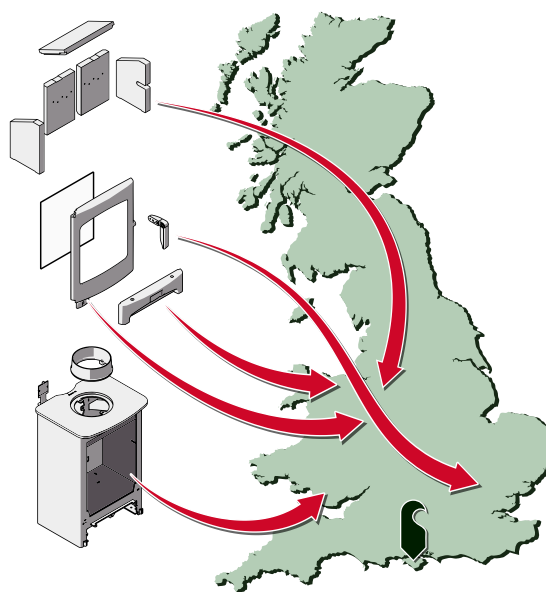

Part of the success of Charnwood has been due to the loyal following of our customers. We always aim to give first class service and ensure all our customers' needs are met. Whether it is for installation advice, reassurance on operation or the need for spare parts we always strive to put the customer first. As a family business, with ten family members working in the company, we recognise the need for personal attention to detail and we always seek to give just that.

CLEAN BURN WOOD & MULTI-FUEL HEATING

There is nothing quite like heating your home with a real Charnwood fire. Not only does the ritual of loading a stove give a greater sense of achievement and satisfaction, it provides a warmth that no other energy source can equal.

We at Charnwood have unrivalled in-depth knowledge of real-fire heating and continue to invest a great deal of time and money into innovative stove design and development. Our appliances are a result of our intense research and over the years we have been at the forefront of the new generation of clean burning ultra efficient stoves. We led the way in Ecodesign Ready stoves in 2022 as new regulations came into force and we are currently one of the first to market with intelligent stoves. Our stoves are advanced appliances that deliver a reliable burn providing warmth to the whole of your property and all with an amazing degree of control, economy and environmental friendliness. The bodies of our stoves are

British built from the best combination of materials for durability and design aesthetics: plate steel, cast iron, fire brick and ceramic glass. These materials offer the best in strength and versatility with excellent heat retention properties. They also allow the stove to be tightly sealed ensuring optimum control over the burn rate - close down the air supply for a gentle burn or open it right up for an intense, blazing fire. The throat plate on all of our models can be taken out with ease, enabling the cleaning of the flueways and the chimney without the inconvenience of removing other internal fireparts. All our stoves are designed and tested to EN16510, ensuring the very best in efficiency, safety, design and construction.





CLEARSKIES MARK • All Charnwood stoves are clearSkies certified and feature our revolutionary BLU technology. This helps to significantly reduce particle emissions while ensuring high efficiencies, easy and controllable operation all with a superior flame picture. clearSkies is a UK-wide programme to help lower emissions and improve air quality. A clearSkies certified stove demonstrates the appliance meets and exceeds Ecodesign standards. A clearSkies level 3 appliance meets Ecodesign standards and includes Defra exemption, a clearSkies level 4 is a 15% improvement on Ecodesign standards and is Defra Exempt and a clearSkies level 5 is a 15% improvement on level 4 and Defra exempt. clearSkies certified stoves are the most environmentally friendly stoves available on the market today and benefit from:

- *Low Particle Emissions: 90% better than open fires*
- *Between 80-84% better than older stoves*
- *Low CO emissions*
- *High efficiencies*
- *Improved flame picture*

CLEAN-BURN AIR-WASH • All the wood-burning and multi-fuel stoves featured in this brochure incorporate the latest clean-burn and air-wash technology. This means when burning your choice of fuel the volatile by-products emitted by the initial burning are re-ignited and burnt again in the fire. This double combustion drastically reduces emissions and ash deposits and delivers even more warmth to your room. Altogether a cleaner home, a cleaner chimney and much cleaner for our environment. In addition to this, the clean-burn airwash also keeps the glass doors beautifully clear, giving you an uninterrupted view of the fire.

10 YEAR GUARANTEE & 3 YEAR NO-QUIBBLE CONSUMABLES GUARANTEE • When purchased through an official, authorised stockist and registered using the code given by them the bodies of our stoves are covered by a *10 year guarantee*. Additionally we offer a *3 year no-quibble guarantee* for all consumables. This includes glass, fire brick and rope seals. For stoves not registered using the code a standard 1 year guarantee is available, which does not include consumables. Visit our website or speak to your stockist for further details and terms and conditions.

VERSATILITY • Within the Charnwood range there is a model to suit every home requirement. For the ultimate in contemporary home heating we offer the Aire, Skye, Arc, Cove and the Bay. For a classic interior we offer the Cranmore, Haven, Island, C-Series, Bembridge and the Country 4.

ENVIRONMENT • Governments across the world are committed to reducing CO₂ emissions and with a Charnwood you too can play a part in this. When you burn wood on a highly efficient stove you reduce the need for other forms of heating and in turn do your bit to save fossil fuels, CO₂ emissions and the planet!

A Charnwood stove also gives you the freedom from dependence on the large energy utilities. At a time when there is increasing concern over stability of supply throughout the world it is nice to know that a Charnwood gives that certainty of warmth during periods of interrupted supply.



STOVES

WOOD AND MULTI-FUEL

unrivalled and uncompromised



charnwood INTELLIGENT STOVES

Effortless, smarter burning. Load it, light it, leave it.

Our new Charnwood intelligent stoves are micro processor controlled appliances that revolutionise the way we burn wood. Load the fire, close the door and let the stove do the rest. It is as simple as that.

These stoves use Charnwood I-Blu combustion technology that continuously monitors the state of the fire and optimises efficiency while reducing emissions through real-time adjustments. Air is introduced in just the right amounts, in the right places, at exactly the right time to ensure a cleaner, highly efficient burn. Good for air quality and the environment, good for saving fuel and good for giving a crystal clear view of the fire.

Intuitive smart E-Controller that runs your stove automatically.

Patented I-Blu air delivery system for an ultra-clean automated burn.

The burn can be monitored or adjusted using the Charnwood Control App on your phone or tablet or by pressing the button on the front of the stove



POWERED BY
CHARNWOOD'S INTELLIGENT
COMBUSTION TECHNOLOGY





SKYE E700

The Skye E700 is designed for everyone, simplifying the burning process by offering effortless operation and unmatched efficiency. Whether you prefer to manage the stove using the app or let it run itself, the stove ensures optimal performance every time.

Because the stove controls itself the results we publish reflect real-world performance, not just test conditions. This ensures you'll enjoy the same consistent efficiency and clean burn in your home as we do in our laboratory.



POWERED BY
CHARNWOOD'S INTELLIGENT
COMBUSTION TECHNOLOGY



AIRE 300

The Aire 300 is the most compact model in our Intelligent stove collection, but don't be fooled by its size. With a heating output of 3.9kW and an exceptional efficiency of over 86%, this stove is designed to deliver outstanding performance in the smallest spaces. Whether you are heating a cabin, a narrowboat, a yurt or a smaller modern home, the Aire 300 does all the work for you.

Pair it with the optional Charnwood Stove Pod, which serves as both a protective casing and hearth plate, allowing you to safely create an instant focal point in the room.



POWERED BY
CHARWOOD'S INTELLIGENT
COMBUSTION TECHNOLOGY



AIRE 400

The Charnwood Aire 400 is the latest addition to the Aire Intelligent collection, bringing advanced control to a beautifully balanced design. Delivering a comfortable 5kW heat output, it combines highly efficient performance with a striking landscape view of the fire. Its wider form and shallow depth create a bold focal point while remaining perfectly suited to contemporary or traditional living spaces.

Equipped with intelligent clean burn technology, the Aire 400 manages its own airflow to ensure optimal efficiency and an exceptionally clear flame picture. Simply load, light and let the stove take care of the rest - providing effortless warmth, refined control and outstanding fuel economy.



POWERED BY
CHARWOOD'S INTELLIGENT
COMBUSTION TECHNOLOGY



AIRE 500

With a range of 2-7 kW, the Aire 500 stove is designed to fit perfectly into your space and provide you with powerful, clean heat exactly when you need it. Whether the stove is installed in a traditional fireplace or freestanding in the room, you can let the microprocessor take full control of the burn.

With its sleek, minimalist design and smart internal mechanism, the Aire 500 delivers intelligent heat that is as stylish as it is efficient.



POWERED BY
CHARNWOOD'S INTELLIGENT
COMBUSTION TECHNOLOGY



AIRE 700

Designed for larger rooms and open spaces, the Aire 700 offers an impressive 6.6kW of clean, controllable heat, all with extraordinary style. It features one of the largest panoramic glass windows ever created by Charnwood, providing a stunning view of flames that are as hypnotic as they are efficient. Simply load it, light it and relax: the stove's intelligent technology takes care of everything else.

This is a next-generation wood stove: clean, efficient, and naturally beautiful.



POWERED BY
CHARNWOOD'S INTELLIGENT
COMBUSTION TECHNOLOGY

*Opposite: Aire 700 on Store Stand in Black
Above L-R: Aire 700 Low, Aire 700 Store Stand*

charnwood HAVEN

A new compact wood-fired cook stove

Combining the charm and functionality of a traditional range with the very latest efficiencies and clean burn technology the Haven features an oven, hot plate and a large glass window for a beautiful view of the fire. The integrated thermometer allows for greater temperature control and cooking accuracy. It's a surprisingly versatile and delicious way of cooking, allowing you to create soups, roasts, cakes, bakes and more!

Large hotplate to accommodate a stove top kettle and a wide range of pots and pans.

Large glass window for a beautiful view of the fire.

Beautifully simple to operate with one single air control using the patented Quattroflow® air management system.

Generous 29 litre stainless steel lined oven complete with wire racks and baking tray.

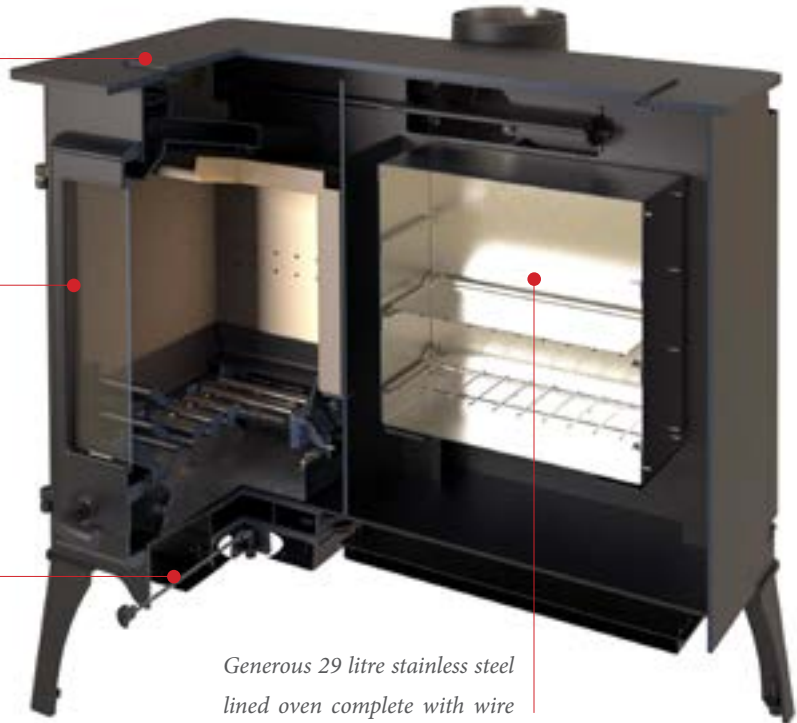

The Haven has been independently certified to conform to EN16510 and meets the UK building requirements for installation with a 12mm non-combustible hearth.





HAVEN

The Charnwood Haven offers a heat output of around 7kW, providing the room with ample warmth through an exceptionally efficient and clean-burn.

Designed to cater to a diverse range of living spaces, from cosy cabins and tiny homes to self-sufficient off-grid environments, this stove stands as a versatile heating and cooking solution.

Its adaptability, however, extends beyond alternative dwellings and can be integrated into conventional homes where lounging, dining and cooking is merged within an open plan layout.



charnwood CRANMORE

Traditional styling, innovative design: A modern classic

This latest stove collection takes inspiration from the Regency era with a single framed glass door and archetypal detailing. The pleasing proportions of the Cranmore make it well suited to a traditional fireplace and with a large picture window it is an ideal replacement for an open fire. The stove can also work equally well in a freestanding situation.

Available in 3 sizes and as an insert stove the Cranmore uses Charnwood clean burn Blu technology and is exceptionally efficient with a clearSkies level 5 rating.

New firebrick and air technology produces a mesmerising flame pattern.

A single door frames the fire.

Sliding firebed for clean and easy ash removal.

One single air control using the patented Quattroflow® air management system.



The Cranmore has been independently certified to conform to EN16510. Both meet the UK building requirements for installation with a 12mm non-combustible hearth

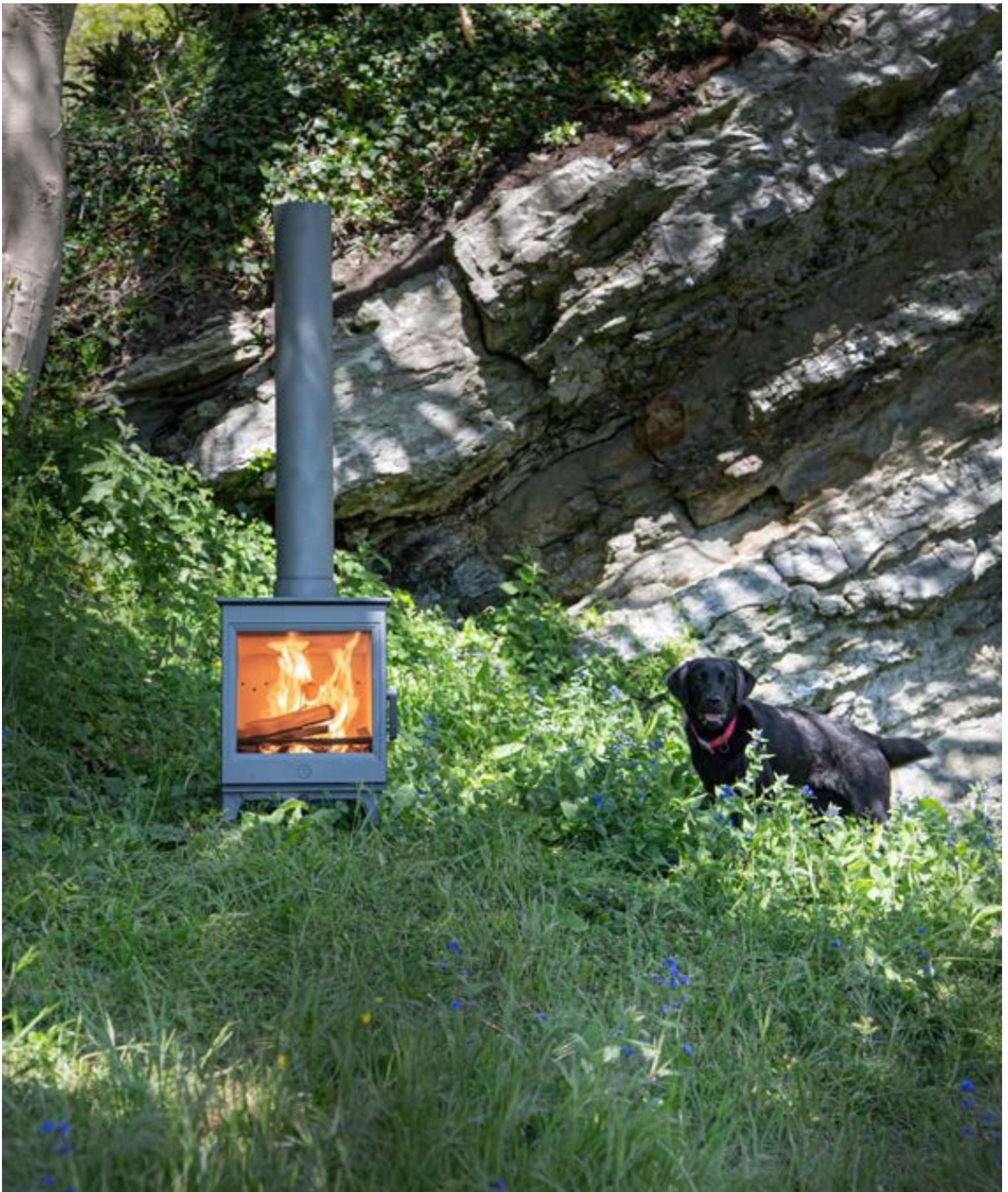



CRANMORE 3

This classic new addition to the Cranmore collection provides a respectable 3.7kW to the room and an efficiency of 86%. The Cranmore 3 has been designed specifically for smaller rooms and traditional spaces. It is also compatible with the Charnwood Stove Pod.





CRANMORE 5

The Charnwood Cranmore 5 provides 2-5kW of heat to the room with a beautifully clear view of the fire. While classic in style the stove features the very latest in clean burn technology. Perfect for period properties that are looking for a sustainable and environmental form of room heating.





CRANMORE INSERT

The Charnwood Cranmore Insert has a rated output of 5KW and is designed to fit into a standard fireplace making it an ideal replacement for a traditional open fire. Featuring a single air control and an integrated outlet for ducting external air the Cranmore Insert delivers unparalleled cleanliness and optimal burning efficiency.





CRANMORE 7

The Charnwood Cranmore 7 is designed for spacious rooms and living areas with a hearty 7kW output. The stove features one single door that elegantly frames the large view of the fire.



charnwood AIRE

A mesmerising flame pattern with a crystal clear burn

The Charnwood Aire is a range of simply styled wood burning stoves. Designed with a very large view of the fire we have also incorporated new and improved burn technology that not only meets and goes beyond the new 2022 Ecodesign standards and Defra exemption requirements but delivers one of our most impressive flame pictures.

The Aire is available in 3 sizes with low or store stand models to choose from in a choice of eight colours.

Innovative airflow technology produces an exceptional clean-burn flame pattern.

Large view of the fire.

Sliding firebed for clean and easy ash removal.

Beautifully simple to operate with one single air control using the patented Quattroflow® air management system.

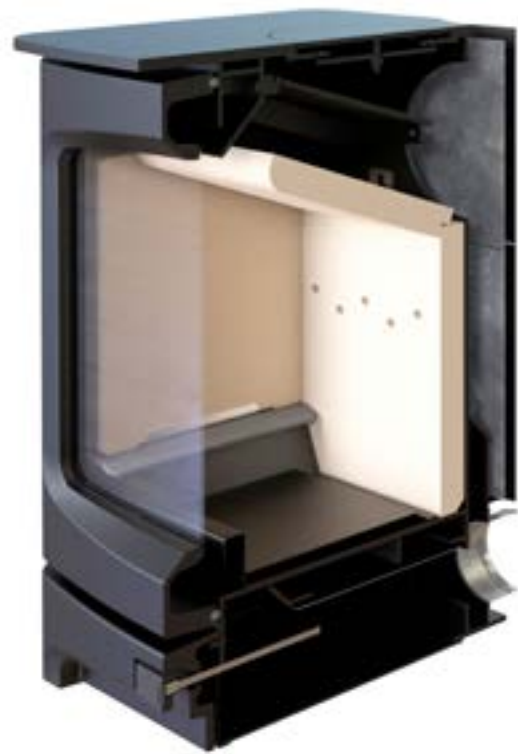

The Aire has been independently certified to conform to EN16510 and meets the UK building requirements for installation with a 12mm non-combustible hearth.





AIRE 3

This compact log burner is our smallest stove in our Charnwood Aire collection. With a 3.7kW output delivering an impressive efficiency of 86% the Aire 3 has been designed for smaller spaces. Not just for conventional houses - but for cabins, house boats, yurts and other types of tiny homes.

We also offer a standalone hearth and chamber enclosure for this model; the Charnwood Stove Pod.





AIRE 4

The Charnwood Aire 4 is the newest addition to the Aire collection. It offers a comfortable 2-5kW heat output, combining efficient performance with a striking landscape view of the fire. Designed with a wider form and shallower depth, it creates an impressive focal point while remaining perfectly suited to modern living spaces. With its clean burn technology and precise controllability, the Aire 4 delivers both warmth and ease of use. Its understated, contemporary styling ensures it sits effortlessly in a variety of settings, whether freestanding or installed within a traditional fireplace.





AIRE 5

The Charnwood Aire 5 delivers a comfortable 2-5kW of heat to the room with a crystal clear burn and remarkable controllability. Deliberately designed to maximise the view of the fire the minimal styling of the Aire fits comfortably into virtually any fireside situation whether it be freestanding or within a traditional fireplace.





AIRE 7

The Charnwood Aire 7 offers an impressive 7kW output and has been designed for larger rooms or open plan areas. Featuring one of our largest ever picture windows the Aire 7 burns with a mesmerising flame pattern that is second to none.



Opposite: Aire 7 Low in black on Charnwood Fireside hearth plate in quilted graphite
Above L-R: Aire 7 Low, Aire 7 Store Stand

charnwood SKYE

Refreshingly simple to use with an exceptional clean burn

The Charnwood Skye is a state-of-the-art multi-fuel stove with a remarkably efficient combustion system. It's innovative burn technology ensures efficiencies of up to 86% and is a vast improvement on the new Ecodesign standards and Defra exemption requirements; allowing wood to be burnt cleanly in smoke control areas. As thoughtful in style as it is in function the Skye has a refreshing design aesthetic – it is classically minimal with landscape proportions and a soft modern edge.

The Skye is available in two sizes: a 5kW and 7kW both in a choice of eight colours and in two stand variations: low or with a store stand.

The Skye's clean design features a seamless flue connection and convection panels to reduce distances to combustible materials; allowing installation into tight spaces.

Flexible fuel choice with an adjustable converting grate for wood and smokeless fuels.

Simple to operate with one single air control using the patented Quattroflow® air management system.



The Skye has been independently certified to conform to EN16510 and meets the UK building requirements for installation with a 12mm non-combustible hearth.





SKYE 5

The Charnwood Skye 5 is our most efficient wood burning and multi-fuel stove to date. With a rated output of 5kW it delivers a comfortable 2-5kW of heat to the room with an exceptional clean burn. The simple, modern styling of the Skye ensures it looks equally as good in a freestanding situation as it does in a fireplace.





SKYE 7

The Charnwood Skye 7 adds an air of contemporary grandeur to any open plan area or room of larger proportions. With a rated output of 7kW it will produce between 5-11kW of heat with a generous view of the fire.



Opposite: Skye 7 Low in black on Vlaze hearth plate in black
Above L-R: Skye 7 Low, Skye 7 Store Stand

charnwood ARC

The stove of a new generation: clean, green and fuel efficient

The Charnwood Arc is a revolutionary multi-fuel stove. It simplifies the process of burning wood and smokeless fuels setting the benchmark for a new generation of modern, clean-burning stoves.

Engineered from the very best combination of materials the Arc utilises years of research and development into low emission burning.

Beneath the Arc's clean, modern lines lies an innovative combustion system that ensures the stove burns exceptionally clean with outstanding efficiencies of over 80%. The Arc is clearSkies certified and Defra exempt; allowing wood to be burnt in smoke control areas.

The Arc is available in two sizes: a 5kW and 7kW both in a choice of eight colours and in two stand variations: low or with a store stand.



CE The Arc has been independently certified to conform to EN16510 and meets the UK building requirements for installation with a 12mm non-combustible hearth.



Convection panels reduce rear distance to combustibles to 80mm allowing installation into tight spaces.

Flexible fuel choice with our adjustable converting grate for wood and multi-fuel.

Simple to use with single air control, our patented Quattroflow[®] air management system and integrated external air connection.



ARC 5

The Charnwood Arc 5 produces between 2-7kW of heat with a rated output of 5kW. Operated by one single air control the combustion system drastically reduces emissions and gives a superior flame pattern. The Arc's pared down simplicity makes for a thoroughly stylish option for modern urban settings as well as more traditional homes.





ARC 7

The Charnwood Arc 7 delivers an output of 7kW and is particularly suited to larger rooms or open plan areas. It is a true multi-fuel stove with exceptional clean burn technology. The Arc 7's contemporary design features an inverted flue collar for a seamless flue connection.





charnwood COVE

Optimum performance with a soft, contemporary aesthetic

The Cove is one of Charnwood's most revered range of wood burning stoves: a union of the very best features of our past and present stoves finished with a soft contemporary edge. One single, curved door offers a breathtaking view of the fire whilst its highly advanced combustion system ensures optimum efficiency and an exceptionally clean burn - more heat from less fuel.

Whilst the Cove is sophisticated in design, it is incredibly simple to operate. One multi-functional tool is used to open the door, de-ash and empty.

The Cove features Charnwood's unrivalled converting grate, advanced clean burn technology and the patented Quattroflow[®] air management system. An optional external air kit is also available enabling an outside air supply to be channelled directly into the stove through the rear of the Quattroflow[®] box. The Cove stove is available in two sizes with a choice of five base options and eight Charnwood colours. Optional convection panels are also available for each of the stoves. These gently convect heat into the room and reduce the side distances to combustibles to 250mm.



The Cove has been independently certified to conform to EN16510 and meets the UK building requirements for installation with a 12mm non-combustible hearth.



Optional side convection panels and rear heat shield.



Two outputs.



Five base options.

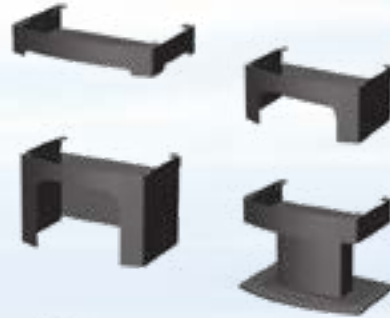

Converting grate.



Quattroflow[®] air management system.



COVE 2

With its gentle curved door and soft lines the Charnwood Cove 2 creates a powerful focal point for any room. This stove delivers a respectable 8kW of heat with a maximum output of 11kW and is Defra exempt; allowing wood to be burnt safely and cleanly in smoke control areas. The base options (as pictured opposite) give the stove five very different looks. The low stand and low arch are perfect for fitting the appliance into a standard fireplace opening whilst the store stand and centre stand are ideal for a large inglenook or a freestanding situation. Optional convection panels are also available.





COVE 3

The Charnwood Cove 3 is the largest stove in the Cove range. With a rated output of 12kW and a maximum of 16kW it is ideally suited to a larger room, hall or open plan area. The Cove 3 is able to take a log length of up to half a metre and with its tall curved door offers a spectacular view of the fire. Once again it comes with a versatile choice of five base options, convection panels and eight colour ways to suit different situations.





charnwood ISLAND

An iconic double door stove

The iconic Charnwood Island range sets the standard for clean-burning multi-fuel stoves. When first launched, this collection revolutionised multi-fuel home heating and became the benchmark in clean-burning environmentally friendly single controlled stoves.

The updated Island range is clearSkies certified incorporating our Blu technology. The Island I and II are multi-fuel options that are based on the original design, but now feature cleaner lines and a larger picture window. The highly acclaimed Island III has also been retained, though as a wood-burning option only.

The Island range is available in three sizes, with low leg, high leg or store stand options and in a choice of eight Charnwood colours.





The ultimate converting grate for burning your chosen fuel at optimum efficiency.

A 'cool to touch' handle for safe and easy reloading.

One simple air control - the Quattroflow® - push in to burn slower, pull out to burn faster.



All Island stoves have been independently certified to conform to EN16510 and meet the UK building requirements for installation with a 12mm non-combustible hearth.

ISLAND I

The Charnwood Island I is the smallest stove in the Island collection. Its uncomplicated looks and gentle curves ensure it sits well in any situation; be it modern or traditional. Delivering an output of 2-7kW of heat it can take a log length of up to 370mm (14.5"). With a rated output of 5kW the All New Island I, in certain situations, can be installed without the need for external air. This stove is Defra exempt and boasts an efficiency of over 85% and an extremely low smoke particle level of 9mg/m³ (the Ecodesign limit is 40mg/m³).





ISLAND II

The Charnwood Island II is the middle stove in the Island collection. With a larger view of the fire it still retains its clean-line proportions while producing a rated 8kW of heat to the room. This stove is Defra exempt when burning wood in smoke control areas and burns with an efficiency of over 82% with an extremely low smoke particle level of 14mg/m³ (the Ecodesign limit is 40mg/m³).





ISLAND III

The Charnwood Island III is the largest stove in the Island collection. Its majestic proportions make it ideal for larger rooms and open plan areas. Producing 11kW of heat, this wood-burning only stove can hold a sizable log length of over half a metre. The Island III offers a spectacular view of the fire; a true wide-screen experience. Optional convection panels are also available.





charnwood BAY

A modern insert or freestanding fire with innovative clean burn technology

The Bay is an award-winning wood burning stove from Charnwood. The stove features a large landscape window. Delivering 5kW of heat to the room the Bay features our Blu burn technology and is incredibly simple to operate with one single air control and a cool-to-touch handle.

The Bay is available as a clean lined insert stove, the Bay VL, or a freestanding version, the Bay BX. This can either be placed directly on the hearth or on a choice of optional stands.

Both models meet the requirements for Ecodesign 2022 and are Defra exempt; allowing wood to be burnt in smoke control areas.

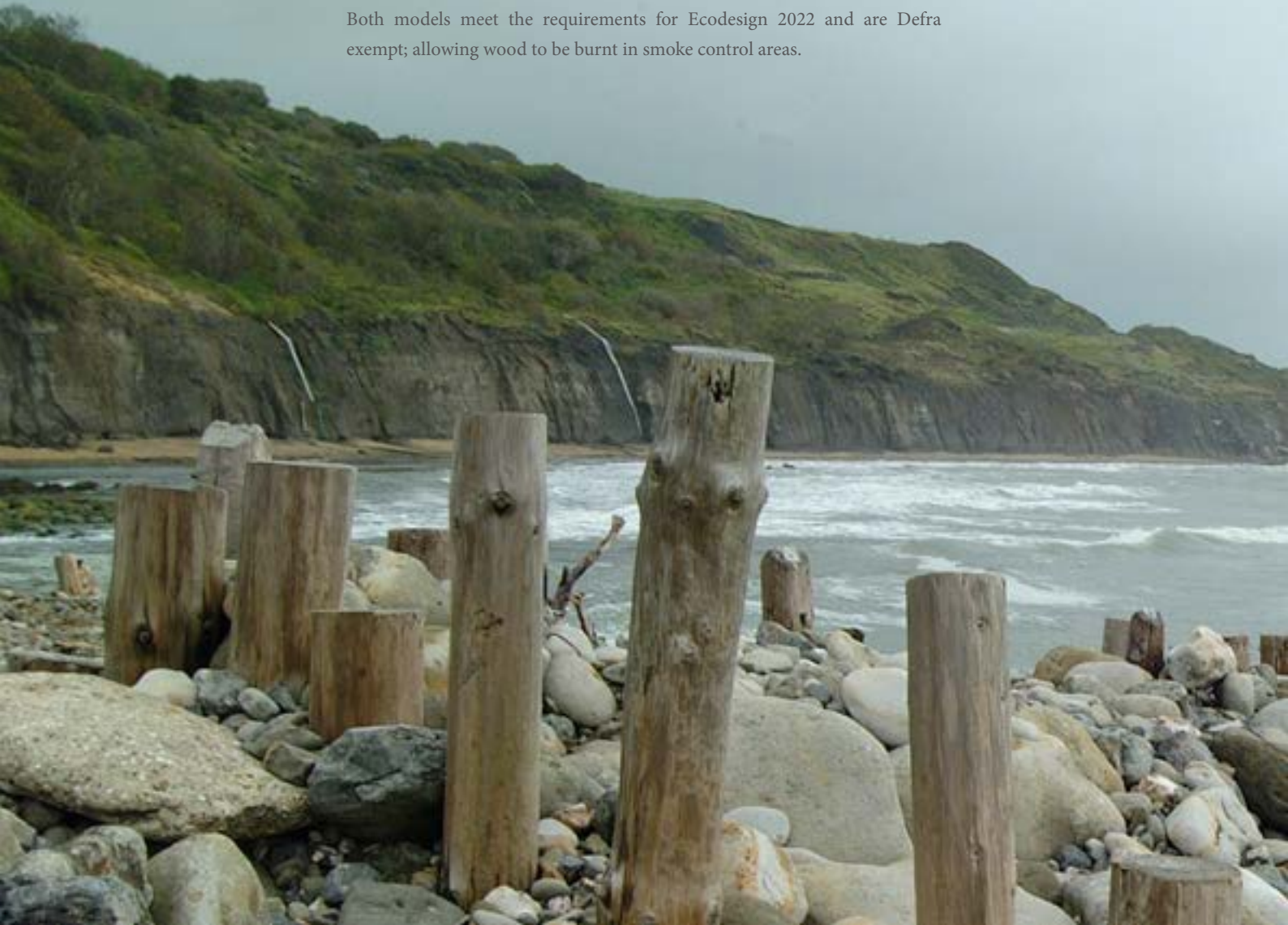

Built from the best combination of cast iron, plate steel and ceramic glass the Bay is brick lined and is designed for easy installation.

Cool-to-touch handle and air controls for safe operation and re-fuelling.



The Bay has been independently certified to conform to EN16510.



BAY VL

The Charnwood Bay VL is a contemporary insert stove featuring a large landscape window framed with a clean, sharp-edged surround. It is Defra exempt; allowing wood to be burnt in smoke control areas. The stove boasts a variable output of between 2 and 7kW and is available in a choice of eight colours.





BAY BX

The Charnwood Bay BX is the latest addition to the Bay range. The firebox and frame of the stove is the same as the Bay VL but features an outer casing transforming the appliance into a freestanding stove. The Bay BX can be installed directly onto a hearth or we offer a choice of three base options to raise the stove up: bench stand, centre stand or store stand. Both the stove and base options are available in eight colours.







charnwood C-SERIES

Quintessential Charnwood: Classic design with impressive performance

The C-Series is a range of classically styled wood burning stoves that feature one single air control and an integrated inlet for ducting external air to improve performance and efficiency.

The C-Series stoves deliver an exceptionally clean burn with outstanding efficiency and all models are Defra exempt; allowing wood to be burnt in smoke control areas. The C-Series stoves are all clearSkies certified and exceed the Ecodesign regulations. All models are available with an optional store stand or high legs to raise the stove off the ground. A rear heat shield is also available enabling the stove to be placed closer to the wall.

In addition we also offer three multi-fuel options: the popular C-Four Insert with a built in converting grate and the C-Four *Duo* and C-Five *Duo* with a fixed grate and ash pan.



C-FOUR

Featuring a large picture window the Charnwood C-Four is the smallest model in the C-Series delivering a heat output to the room of between 2 to 5.5kW. The stove is fire brick lined and can take a log length of up to 282mm (11”). With a rated output of 4.9kW the C-Four, in certain situations, can be installed without the need for external air. This stove is Defra exempt; allowing wood to be burnt in smoke control areas.

We also offer a multi-fuel version of this model: the C-Four *Duo* with a fixed grate and ash pan.





C-FOUR INSERT

Based on the freestanding Charnwood C-Four this stove is designed to fit into a standard fireplace. Featuring a single air control and an integrated outlet for ducting external air the C-Four Insert burns exceptionally clean with outstanding efficiency. This stove is Ecodesign Ready when burning wood and features our renowned converting grate for efficient ash removal. The C-Four Insert is also Defra exempt; allowing wood to be burnt in smoke control areas.

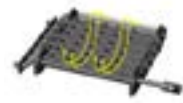





C-FIVE

The Charnwood C-Five has a similar output to the C-Four but it is built with landscape proportions to take a slightly longer log length; 351mm (14"). The stove is fire brick lined and in certain situations, can be installed without the need for external air due to its rated output of 5kW. This stove is Defra exempt; allowing wood to be burnt in smoke control areas.

We also offer a multi-fuel version of this model: the C-Five *Duo* with a fixed grate and ash pan.



C-SIX

The Charnwood C-Six is a 5.9kW stove delivering between 5 and 7kW of heat to the room. The stove is fire brick lined and can take a log length of up to 307mm (12"). This stove is Defra exempt; allowing wood to be burnt in smoke control areas.





C-SEVEN

The Charnwood C-Seven, like the C-Five, is built with a wide picture window and landscape proportions to take a longer log length; 430mm (17"). The stove has a rated output of 7.1kW and is fire brick lined. This stove is Defra exempt; allowing wood to be burnt in smoke control areas.





C-EIGHT

The Charnwood C-Eight is the largest stove in the C-Series. With an 8kW output the stove features an impressive portrait picture window and takes a 366mm (14") log. With majestic proportions the C-Eight is suited to larger fireplaces and living spaces. This stove is Defra exempt; allowing wood to be burnt in smoke control areas.







COUNTRY LIVING

The Bembridge

WOOD BURNING STOVE FROM CHARNWOOD

The Country Living Bembridge is an innovative wood burning stove made exclusively in partnership with Country Living magazine.

Featuring a removable door handle, one single air control and an integrated inlet for ducting external air, The Bembridge burns exceptionally clean with outstanding efficiency.

The Bembridge is Defra exempt; allowing wood to be burnt in smoke control areas.

The Bembridge incorporates our latest *Blu* technology and is clearSkies level 5 certified exceeding Ecodesign regulations.

The stove is available in a choice of 4 colours: Almond, French Grey, Gunmetal and Black.

Other options include a store stand and high legs to raise the stove off the hearth, and a drop-in grate to assist with ash removal.



The Bembridge has been independently certified to conform to EN16510





charnwood COUNTRY 4

A traditional, time-honoured stove

The Charnwood Country 4 is a neat, sturdy, yet graceful little fire and with a rated output of 5kW can be installed in certain situations, without the need for external air. The single door gives a complete, crystal clear view of the fire. In spite of its size, the Country 4 takes a decent-sized log length of 332mm (13") making it a very popular choice in the small stove market. The stove is available in a choice of eight Charnwood colours and finished with touches of solid brass and a turned wooden door handle. The Country 4 is Defra exempt; allowing wood to be burnt in smoke control areas.





INNOVATION

SMART STOVE SOLUTIONS

refining the wood burning process



CONVERTING GRATE

The Charnwood multi-fuel converting grate is the very best grate system on the market. Built into all Skye, Arc, Island, Cove and C-Four Insert models, the grate can be altered to ensure the most efficient burning conditions. By operating a lever on the side of the stove, with the tool provided, a series of grate bars can be set into a closed, flat bed position (the most efficient way to burn wood) or to an open grate for ultra efficient burning where the stove is suitable for mineral fuel. This grate also acts as a highly effective riddling mechanism, neatly dropping the ash into the wall-to-wall pan below for clean disposal. Because the grate is operated externally all of these manoeuvres can be carried out with the doors closed and when the stove is fully loaded and under fire.

CLOSED POSITION for wood and peat - allowing a bed of ash to build up to let the air flow across the fire.



OPEN POSITION for smokeless fuels - allowing the air to flow up through the fuel.



Please note: the converting grate is also built into the Island III, Cove 2 and Haven models but is designed for ash removal only and not multi-fuel burning.

DROP-IN GRATE



The Charnwood drop-in reciprocating grate is designed to assist with ash removal when burning wood. Its neat, external riddling action and ash pan ensure easy cleaning and keep mess to a minimum.

QUATTROFLOW® AIR MANAGEMENT SYSTEM

This is a revolutionary air management system patented by Charnwood and used on the Cranmore, Aire, Skye, Arc, Cove, Island, Bay, Bembridge, C-Series and Haven models. Using a number of air chambers the single control introduces the right amount of air into just the right places for ultra efficient burning and optimum control: pull out to increase the burning rate - push in to slow it down. An outside air supply can be channelled directly into the stove through the rear of the Quattroflow® box.

1 PRIMARY air vent: the main control for faster/slower burning.

2 SECONDARY air vent for clean glass and double combustion.

3 TERTIARY air vent for optimum combustion efficiency.



CHARNWOOD FLUE

Charnwood offer a wide range of stove flue pipe pieces designed to complement the stove ranges. British made from 1mm 316 high quality stainless steel the range includes bends and adjustable lengths. Charnwood Flue is available in 5" (125mm), 6" (150mm) and 7" (178mm) diameters and in the full range of eight Charnwood colours.



HEAT SHIELDS AND CONVECTION PANELS

Charnwood's rear heat shields and convection panels are designed specifically for situations where space within the fireplace is limited. The steel heat shield allows minimum



rear wall clearances to be reduced. The heat shield is available in a number of sizes for the Cranmore, Aire, Cove, Island, C-Series, Bembridge, Country 4 and Haven. Speak to your local stockist or visit www.charnwood.com for further details.

DROP-DOWN THROAT PLATE

All Charnwood stoves are fitted with a drop-down throat plate allowing for the stove to be swept through the appliance saving time and with minimum mess.



FLUE BOILER

The Charnwood Flue Boiler replaces the first few feet of the standard flue rising from the top of the stove and utilises the excess heat from the appliance that would otherwise be lost. In addition to this, because the boiler is external, the stove maintains its high clean-burn combustion efficiency. Depending on the size of stove and subsequent flue boiler, outputs of between 1.8 and 3.4kW can be achieved with minimal effect on the nominal output of the stove. On selected stoves this can provide sufficient heat for domestic hot water and up to 3 radiators. The flue boiler is available in 3 sizes. Speak to the Charnwood technical team or visit www.charnwood.com for further details.



VERTICAL REAR FLUE ADAPTOR

A vertical rear flue adaptor is available for all Cranmore, Aire, Skye, Arc, Island, Cove, C-Series, Bembridge, Country 4 and Haven models. This enables you to position the stove



further out into the room and away from the wall behind. This will add a depth to the stove of between 115-196mm depending on the model. Speak to your local stockist or visit www.charnwood.com for further details.

EXTERNAL AIR KITS

The external air kit enables an outside air supply to be channelled directly into your Charnwood stove. As well as providing further comfort and operational efficiency for your stove our air kits help overcome issues where the room requires an additional air supply.



COOKING PLATE

The Charnwood Cooking Plate is a cast iron plate that simply replaces the blanking plate on a standard Charnwood stove to create a highly effective hot plate for cooking.



The Cooking Plate is ideal for stoves installed into open-plan living areas where the boundaries of cooking, dining and lounging are merged. The set includes four cast iron trivets for versatility when cooking and the plate is available in two sizes: 5" or 6" outlet diameters to suit most Charnwood models.

Please note: the stove will need to be installed using the rear outlet to allow the cooking plate to be fitted on the stove top.

charnwood STOVE POD

*An instant freestanding stove chamber and hearth plate
that is quick and easy to install.*

The Charnwood Stove Pod is a freestanding hearth and chamber enclosure designed for use with our Cranmore 3 and Aire 3 wood burning stoves. The Pod is a quick and easy way of creating an instant fireplace so is perfectly suited to cabins, yurts, houseboats and other types of tiny home accommodation.

The Charnwood Stove Pod can be safely placed 50mm away from combustible materials. It is finished in a durable black powder coat but we also offer the option of a vitreous enamel liner in black and white splatter or clay splatter finish to further enhance the enclosure.



*Opposite: Aire 3 in black with Charnwood Stove Pod in black splatter featuring Charnwood Cook Top
Above L-R: Stove Pod black powdercoat, Stove Pod in black splatter, Stove Pod in clay splatter*



charnwood COLOUR

In addition to the standard Charnwood matt black, we also offer you a choice of seven other shades. It is a simple yet brilliant way to give the heart of your home a new lease of life. Either order your stove in the colour of your choice or purchase one of our paint kits to re-spray the stove yourself whenever you feel like a change.



black



blue



brown



green



almond



bronze



gunmetal



pewter

Charnwood Colour is a specially developed, high temperature stove paint formulated for an easy application. It is suitable for the following stoves in the Charnwood range: Cranmore, Aire, Skye, Arc, Cove, Island, Bay, C-Series and Country 4. The Haven is available in Black and Gunmetal. The Bembridge is available in Almond, French Grey, Gunmetal and Black.

Please note: we have reproduced the colours as faithfully as print will allow however the pictures should not be taken as an exact indication of colour.



CHOOSING YOUR **charnwood**

When choosing your stove it is important to pick the right size stove for your room by taking into account the RATED OUTPUT: This is the kilowatt output achieved in the European standard tests (EN16510). Use this chart or our simple calculator on our website as an initial guide in selecting the most suitable Charnwood stove for your room. It is based on an outside temperature of -1 °C and a room height of 2.4 metres.

PLEASE NOTE: This is an approximate guide only. Your Charnwood Premier Dealer will be able to advise further.

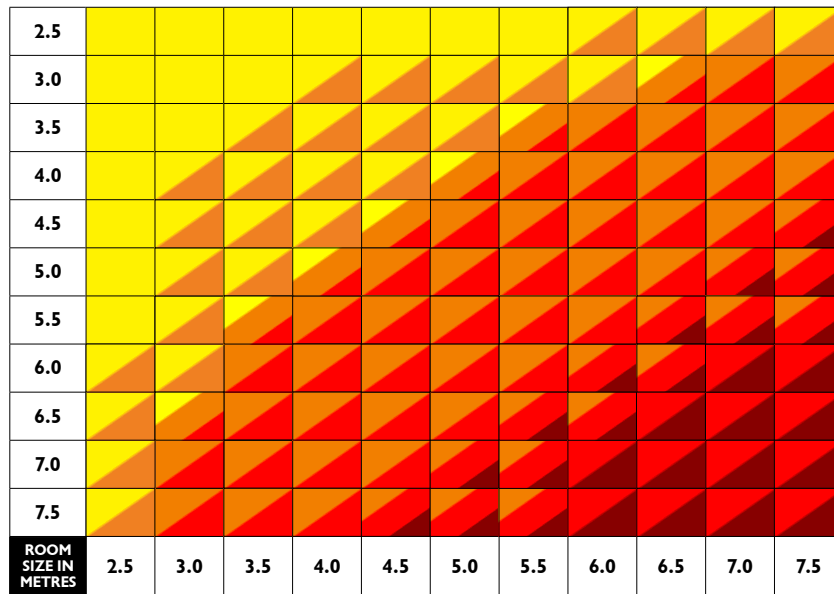

- CRANMORE 3, AIRE 3/300, AIRE 4/400, SKYE 5, CRANMORE INSERT, C-FOUR, C-FOUR INSERT, C-FIVE, THE BEMBRIDGE, COUNTRY 4
- HAVEN, CRANMORE 5, AIRE 5/500, ARC 5, BAY VL, BAY BX, ISLAND I, C-SIX
- CRANMORE 7, AIRE 7/700, ARC 7, SKYE 7, SKYE E700, COVE 2, ISLAND II, C-SEVEN, C-EIGHT
- COVE 3, ISLAND III

charnwood COMPARISON CHART

STOVE MODEL

	AIRE 300	AIRE 400	AIRE 500	AIRE 700	SKYE E700	HAVEN*	CRANMORE 3	CRANMORE 5	CRANMORE INSERT	CRANMORE 7	AIRE 3	AIRE 4	AIRE 5	AIRE 7	SKYE 5	SKYE 7	ARC 5	ARC 7	THE BEMBRIDGE	BAY BX	BAY VL	COVE 2*	COVE 3*	ISLAND I	ISLAND II	ISLAND III*	C-FOUR	C-FOUR Duo	C-FOUR INSERT	C-FIVE	C-FIVE Duo	C-SIX	C-SEVEN	C-EIGHT	COUNTRY 4					
Wood Burning	Standard	Standard	Standard	Standard	Standard	Standard	Standard	Standard	Standard	Standard	Standard	Standard	Standard	Standard	Standard	Standard	Standard	Standard	Standard	Standard	Standard	Standard	Standard	Standard	Standard	Standard	Standard	Standard	Standard	Standard	Standard	Standard	Standard	Standard	Standard	Standard	Standard			
Multifuel									Optional						Optional	Optional	Optional	Optional							Optional	Optional	Optional													
Converting grate									Optional						Optional	Optional	Optional	Optional				Optional	Optional	Optional	Optional	Optional	Optional													
Drop-in grate																			Optional									Optional												
Riddling function						Optional			Optional						Optional	Optional	Optional	Optional	Optional	Optional			Optional	Optional	Optional	Optional	Optional	Optional												
Quattroflow® / Single control																																								
I Blu control	Standard	Standard	Standard	Standard	Standard																																			
Convection panels																Optional	Optional	Optional					Optional	Optional			Optional													
Vertical rear flue adaptor	Optional	Optional	Optional	Optional	Optional	Optional	Optional	Optional	Optional	Optional	Optional	Optional	Optional	Optional	Optional	Optional	Optional	Optional	Optional	Optional	Optional	Optional	Optional	Optional	Optional	Optional	Optional	Optional	Optional	Optional	Optional	Optional	Optional	Optional	Optional	Optional	Optional	Optional	Optional	
Heat shield															Optional	Optional	Optional	Optional	Optional																					
External air kit																					Optional																			
Stand / Leg options																					Optional																			
Stay cool handle	Standard	Standard	Standard	Standard	Standard	Standard	Standard	Standard	Standard	Standard	Standard	Standard	Standard	Standard	Standard	Standard	Standard	Standard	Standard	Standard	Standard	Standard	Standard	Standard	Standard	Standard	Standard	Standard	Standard	Standard	Standard	Standard	Standard	Standard	Standard	Standard	Standard	Standard	Standard	
Removable handle																				Optional			Optional	Optional																
Firebrick lining	Standard	Standard	Standard	Standard	Standard	Standard	Standard	Standard	Standard	Standard	Standard	Standard	Standard	Standard	Standard	Standard	Standard	Standard	Standard	Standard	Standard	Standard	Standard	Standard	Standard	Standard	Standard	Standard	Standard	Standard	Standard	Standard	Standard	Standard	Standard	Standard	Standard	Standard	Standard	
Drop-down throat plate	Standard	Standard	Standard	Standard	Standard	Standard	Standard	Standard	Standard	Standard	Standard	Standard	Standard	Standard	Standard	Standard	Standard	Standard	Standard	Standard	Standard	Standard	Standard	Standard	Standard	Standard	Standard	Standard	Standard	Standard	Standard	Standard	Standard	Standard	Standard	Standard	Standard	Standard	Standard	
Flue boiler										Optional					Optional	Optional	Optional	Optional	Optional	Optional			Optional	Optional	Optional	Optional	Optional	Optional	Optional	Optional	Optional	Optional	Optional	Optional	Optional	Optional	Optional	Optional	Optional	
Front shelf																																							Optional	
Double doors																										Optional	Optional	Optional												
Defra exempt	Standard	Standard	Standard	Standard	Standard	Standard	Standard	Standard	Standard	Standard	Standard	Standard	Standard	Standard	Standard	Standard	Standard	Standard	Standard	Standard	Standard	Standard	Standard	Standard	Standard	Standard	Standard	Standard	Standard	Standard	Standard	Standard	Standard	Standard	Standard	Standard	Standard	Standard	Standard	
(EPC) Energy Efficiency Rating	A+	A+	A+	A+	A+	A+	A+	A+	A+	A+	A+	A+	A+	A+	A+	A+	A+	A+	A+	A+	A+	A	A	A+	A+	A	A+	A+	A+	A+	A+	A+	A+	A+	A	A+	A+	A+		
clearSkies mark	5	5	5	5	5	5	5	5	5	5	5	5	5	5	5	5	5	5	5	5	5	4	2	5	5	2	5	5	5	5	5	5	5	5	5	5	5	5		
Nominal output to room (kW)	3.9	5	5	6.6	7.4	6.6	3.7	5	5	7	3.7	5	5	7	5	7.3	5	7	5	5	5	5	8	12	5	8	11	4.9	4.9	5	5	5	5	5.9	7.1	8	5			

 Standard  Optional

* Please note: the converting grate used in these models is for woodburning ONLY to assist with ash removal.





Luxurious vitreous enamel wall & floor protection for your stove

CHARNWOOD FIRESIDE offer a range of vitreous enamel wall cladding and hearth plates designed specifically for the fireplace. British made by our sister company A.J Wells, the exceptional surface finish is created by fusing powdered glass to steel at temperatures in excess of 800°C. The result is a luxurious, vibrant glaze that boasts excellent thermal properties, does not crack, distort or discolour when exposed to the heat of the stove and wipes clean. The process and finish is identical to that of which A.J Wells use to manufacture the iconic signage and architectural cladding for the London Underground.

FIRESIDE WALL MOUNTED HEAT SHIELDS are designed to be placed behind the stove. When installed the shield reduces the minimum required distance to the face of the panel to 95mm (and just 75mm in the case of a Charnwood stove). The vitreous enamel panel features a dual skin that provides thermal protection and an effective convection system. Using a rail mounted system they are quick and easy to install. The heat shields are available in 3 sizes to suit all our freestanding stove models.

FIRESIDE HEARTH & CHAMBER PLATES create a clean, modern platform on which to stand your stove. An excellent alternative to glass or polished stone they can be used on their own or alongside our heat shields for a seamless floor to wall solution. They can also be mounted to the wall behind the stove to line a fireplace chamber. Each hearth features a smooth radius edge and

is insulated with fire rated fibreboard to take the heat and weight of the stove while still being light to handle. The plates are available in 4 sizes to suit most stoves and boast a 12mm depth conforming to UK building regulations for non-structural hearths.

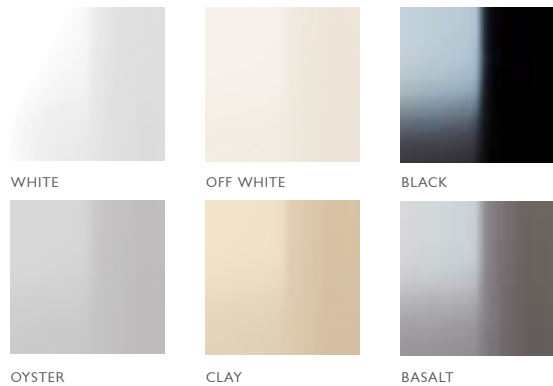

Left: Heat shield and hearth plate in black. Above: Heat shield in Oyster and hearth plate in Basalt.

A black dog, possibly a Labrador Retriever, stands in the lower right corner of the frame. The background is filled with large agave plants, including a prominent one in the center with long, pointed, serrated leaves. The ground is covered in dry leaves and twigs. The sky is clear and blue.

SPECIFICATIONS

FIRES, FACTS AND FIGURES

the ins and outs of our stoves



AIRE 300



RATED OUTPUT

3.9kW to room

NET EFFICIENCY

86.7%

FLUE OUTLET

Top or Rear **125mm (5")** dia.

MAX LOG LENGTH

250mm (10")

WEIGHT

69KG Low, **77KG** Store Stand

MIN DISTANCE TO COMBUSTIBLES

Side: **280mm** Rear: **180mm** With insulated flue & heat shield - Side: **300mm** Rear: **100mm**

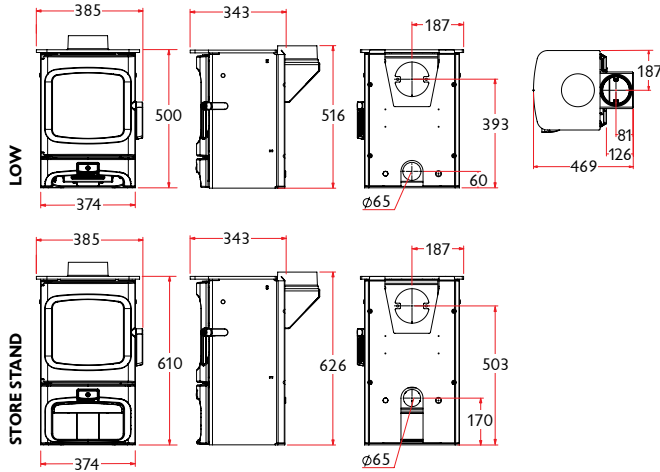

AIRE 400



RATED OUTPUT

5.0kW to room

NET EFFICIENCY

85%

FLUE OUTLET

Top or Rear **125mm (5")** dia.

MAX LOG LENGTH

400mm (15.5")

WEIGHT

87KG Low, **98KG** Store Stand

MIN DISTANCE TO COMBUSTIBLES

Side: **300mm** Rear: **150mm** With insulated flue & heat shield - Side: **300mm** Rear: **60mm**

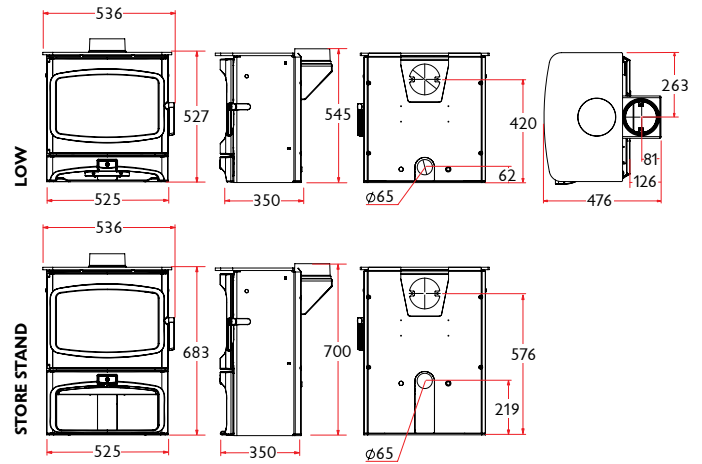

AIRE 500



RATED OUTPUT

5.0kW to room

NET EFFICIENCY

87%

FLUE OUTLET

Top or Rear **150mm (6")** dia.

MAX LOG LENGTH

340mm (13")

WEIGHT

102KG Low, **115KG** Store Stand

MIN DISTANCE TO COMBUSTIBLES

Side: **350mm** Rear: **250mm** With insulated flue & heat shield - Side: **350mm** Rear: **150mm**

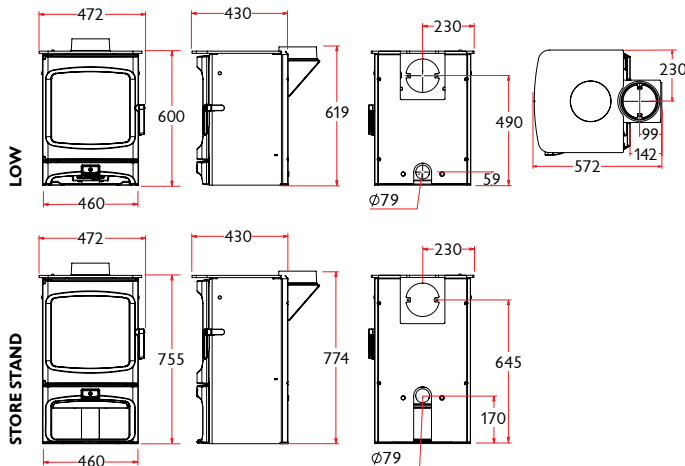

AIRE 700



RATED OUTPUT

6.6kW to room

NET EFFICIENCY

88%

FLUE OUTLET

Top or Rear **150mm (6")** dia.

MAX LOG LENGTH

400mm (15")

WEIGHT

107KG Low, **120KG** Store Stand

MIN DISTANCE TO COMBUSTIBLES

Side: **350mm** Rear: **350mm** With insulated flue & heat shield - Side: **350mm** Rear: **150mm**

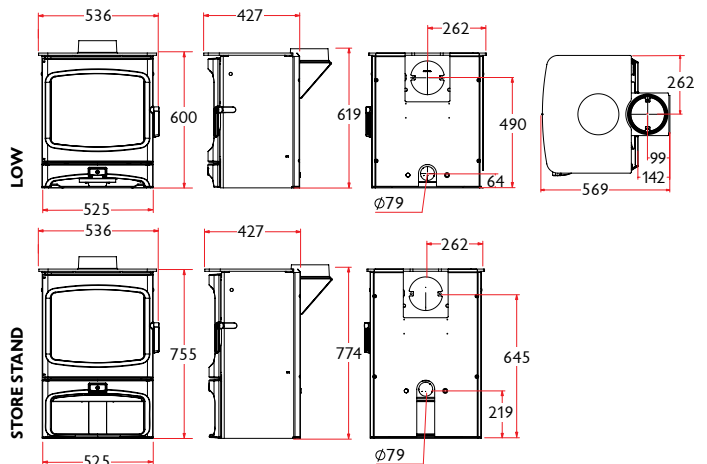



AIRE 3

RATED OUTPUT

3.7kW to room (range 1.5-5kW)

NET EFFICIENCY

86%

FLUE OUTLET

Top or Rear **125mm (5")** dia.

MAX LOG LENGTH

250mm (10")

WEIGHT

62KG Low, **71KG** Store Stand

MIN DISTANCE TO COMBUSTIBLES

Side: **310mm** Rear: **250mm** With insulated flue & heat shield - Side: **310mm** Rear: **100mm**

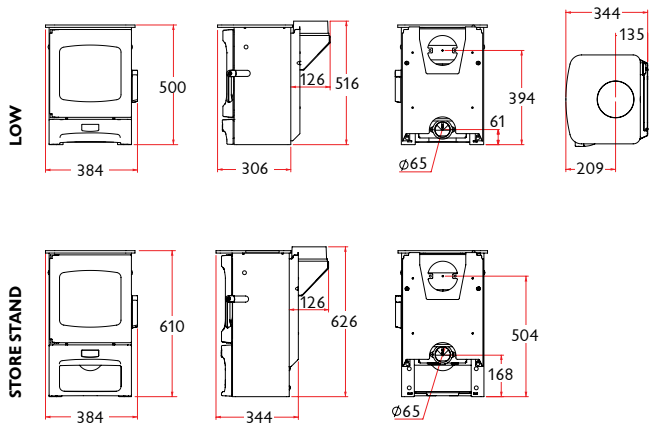

AIRE 4

RATED OUTPUT

4.9kW to room

NET EFFICIENCY

86%

FLUE OUTLET

Top or Rear **125mm (5")** dia.

MAX LOG LENGTH

400mm (15.5")

WEIGHT

87KG Low, **98KG** Store Stand

MIN DISTANCE TO COMBUSTIBLES

Side: **300mm** Rear: **350mm** With insulated flue & heat shield - Side: **300mm** Rear: **60mm**

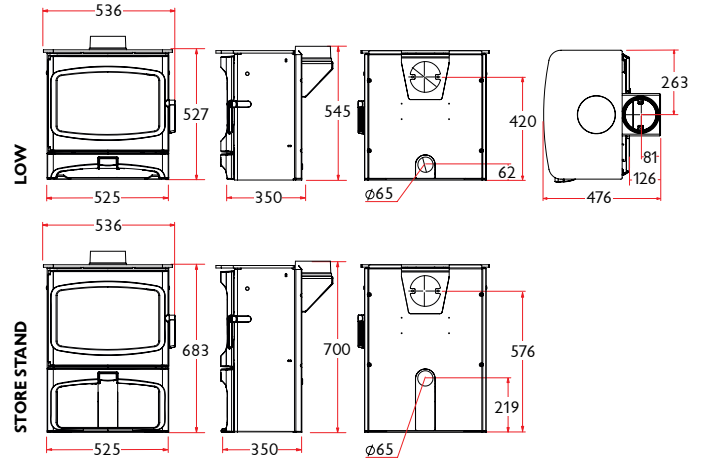

AIRE 5

RATED OUTPUT

5kW to room (range 2-7kW)

NET EFFICIENCY

84%

FLUE OUTLET

Top or Rear **150mm (6")** dia.

MAX LOG LENGTH

300mm (12")

WEIGHT

109KG Low, **123KG** Store Stand

MIN DISTANCE TO COMBUSTIBLES

Side: **350mm** Rear: **350mm** With insulated flue & heat shield - Side: **350mm** Rear: **100mm**

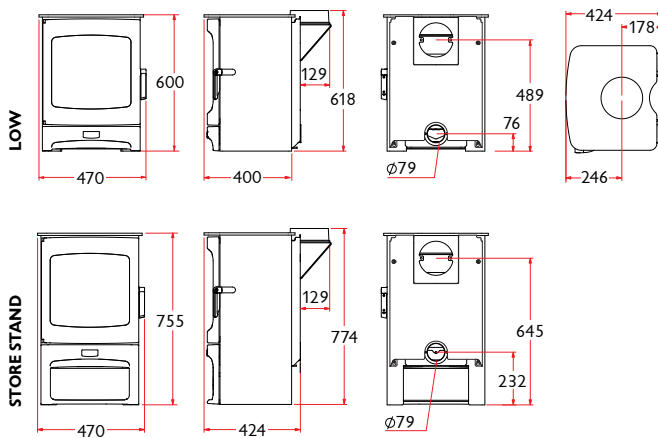

AIRE 7

RATED OUTPUT

7kW to room (range 5-11kW)

NET EFFICIENCY

82%

FLUE OUTLET

Top or Rear **150mm (6")** dia.

MAX LOG LENGTH

390mm (15")

WEIGHT

117KG Low, **135KG** Store Stand

MIN DISTANCE TO COMBUSTIBLES

Side: **420mm** Rear: **360mm** With insulated flue & heat shield - Side: **390mm** Rear: **110mm**

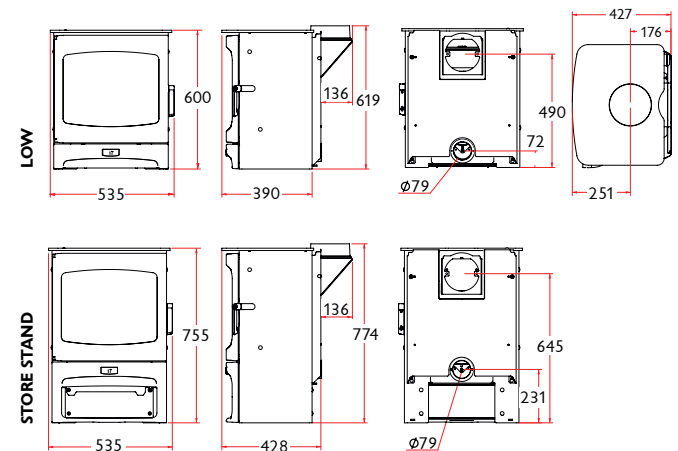

CRANMORE 3

RATED OUTPUT	
3.7kW to room (range 1.5-5kW)	
NET EFFICIENCY	
86%	
FLUE OUTLET	
Top or Rear 125mm (5") dia.	
MAX LOG LENGTH	WEIGHT
250mm (10")	53KG
MIN DISTANCE TO COMBUSTIBLES	
Side: 310mm Rear: 250mm With insulated flue & heat shield - Side: 310mm Rear: 100mm	

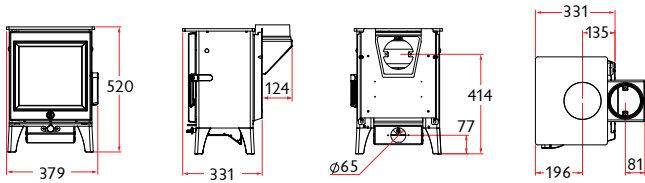

CRANMORE INSERT

RATED OUTPUT	
5kW to room (range 2.5-5.5kW)	
NET EFFICIENCY	
80%	
FLUE OUTLET	
Top or Rear 125mm (5") dia.	
MAX LOG LENGTH	WEIGHT
332mm (13")	100KG
MIN DISTANCE TO COMBUSTIBLES	
Side: 280mm Top: 310mm See instruction manual for internal casing distances	

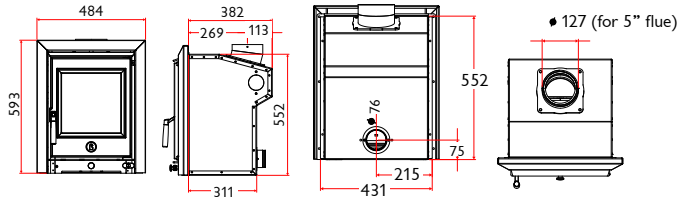

CRANMORE 5

RATED OUTPUT	
5kW to room (range 2-7kW)	
NET EFFICIENCY	
84%	
FLUE OUTLET	
Top or Rear 150mm (6") dia.	
MAX LOG LENGTH	WEIGHT
300mm (12")	85KG
MIN DISTANCE TO COMBUSTIBLES	
Side: 350mm Rear: 350mm With insulated flue & heat shield - Side: 350mm Rear: 100mm	

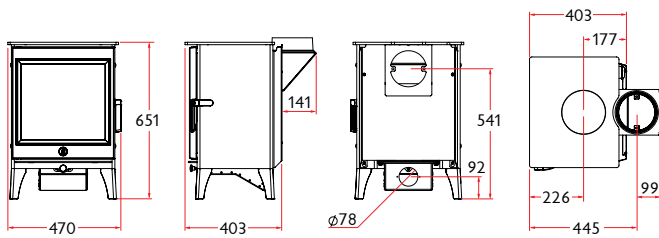

CRANMORE 7

RATED OUTPUT	
7kW to room (range 5-11kW)	
NET EFFICIENCY	
82%	
FLUE OUTLET	
Top or Rear 150mm (6") dia.	
MAX LOG LENGTH	WEIGHT
390mm (15")	94KG
MIN DISTANCE TO COMBUSTIBLES	
Side: 420mm Rear: 360mm With insulated flue & heat shield - Side: 390mm Rear: 110mm	

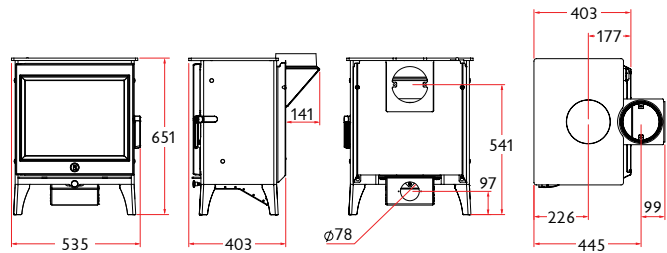

ARC 5

RATED OUTPUT

5kW to room (range 2-7kW)

NET EFFICIENCY

81% Wood, 82% Solid Fuel

FLUE OUTLET

Top or Rear **125mm (5")** dia.

MAX LOG LENGTH

285mm (11.5")

WEIGHT

130KG Low, **150KG** Store Stand

MIN DISTANCE TO COMBUSTIBLES

Side: **300mm** Rear: **200mm** With insulated flue & heat shield - Side: **270mm** Rear: **80mm**

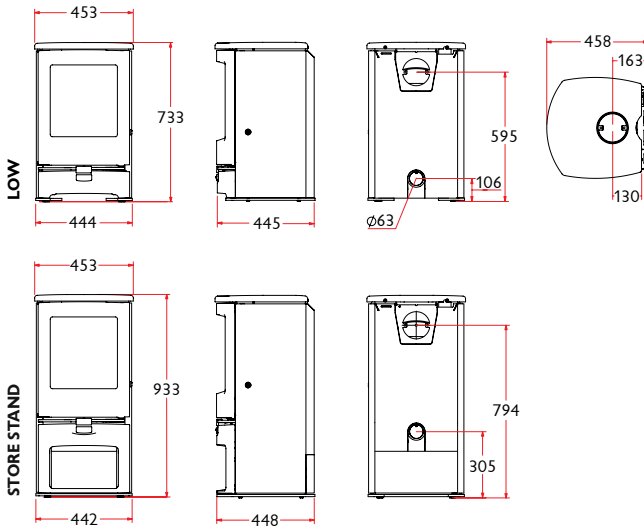

ARC 7

RATED OUTPUT

7kW to room (range 5-11kW)

NET EFFICIENCY

81% Wood, 79% Solid Fuel

FLUE OUTLET

Top or Rear **150mm (6")** dia.

MAX LOG LENGTH

325mm (12.5")

WEIGHT

150KG Low, **170KG** Store Stand

MIN DISTANCE TO COMBUSTIBLES

With insulated flue & heat shield - Side: **270mm** Rear: **150mm**

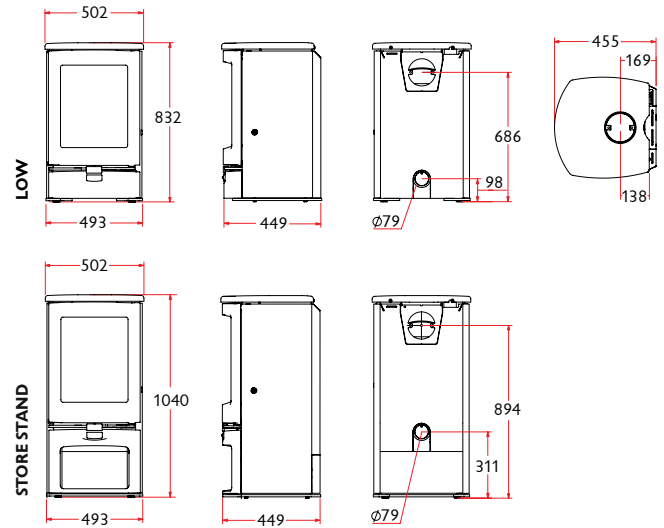

ISLAND I

RATED OUTPUT

5kW to room (range 2-7kW)

NET EFFICIENCY

85% Wood, 78.8% Solid Fuel

FLUE OUTLET

Top or Rear **125mm (5")** dia.

MAX LOG LENGTH

411mm (16")

MIN DISTANCE TO COMBUSTIBLES

Side: **500mm** Rear: **500mm** With insulated flue & heat shield - Side: **500mm** Rear: **100mm**

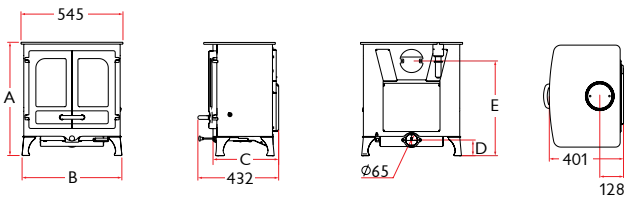

		A	B	C	D	E	WEIGHT
LOW LEGS		611	533	351	85	511	109KG
HIGH LEGS		698	551	329	171	598	110KG
STORE STAND		733	515	300	206	632	117KG

ISLAND II

RATED OUTPUT

8kW to room (range 5-11kW)

NET EFFICIENCY

82% Wood, 79% Solid Fuel

FLUE OUTLET

Top or Rear **150mm (6")** dia.

MAX LOG LENGTH

480mm (19")

MIN DISTANCE TO COMBUSTIBLES

Side: **480mm** Rear: **500mm** With insulated flue & heat shield - Side: **480mm** Rear: **170mm**

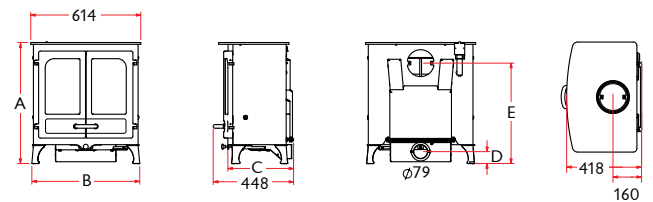

		A	B	C	D	E	WEIGHT
LOW LEGS		675	602	366	66	560	133KG
HIGH LEGS		760	621	330	151	645	134KG
STORE STAND		795	584	299	186	680	140KG

COVE 2

RATED OUTPUT

8kW to room (range 3-11kW)

NET EFFICIENCY

77%

FLUE OUTLET

Top or Rear **150mm (6")** dia.

MAX LOG LENGTH

414 mm (16")

MIN DISTANCE TO COMBUSTIBLES

Side: **450mm** Rear: **600mm** With insulated flue, panels & heat shield - Side: **250mm** Rear: **250mm**

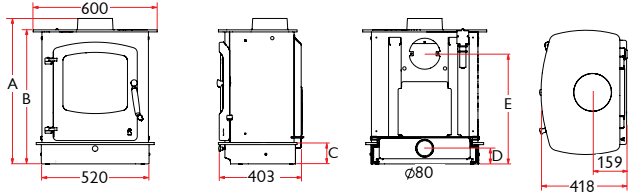

		A	B	C	D	E	WEIGHT
LOW STAND		697	647	103	76	532	127KG
LOW ARCH STAND		697	647	103	76	532	127KG
MIDI STAND		824	774	230	203	659	130KG
STORE STAND		944	894	350	323	779	133KG
CENTRE STAND		944	894	350	323	779	146KG

COVE 3

RATED OUTPUT

12kW to room (range 7-16kW)

NET EFFICIENCY

80%

FLUE OUTLET

Top or Rear **178mm (7")** dia.

MAX LOG LENGTH

481mm (19")

MIN DISTANCE TO COMBUSTIBLES

Side: **500mm** Rear: **600mm** With insulated flue, panels & heat shield - Side: **250mm** Rear: **250mm**

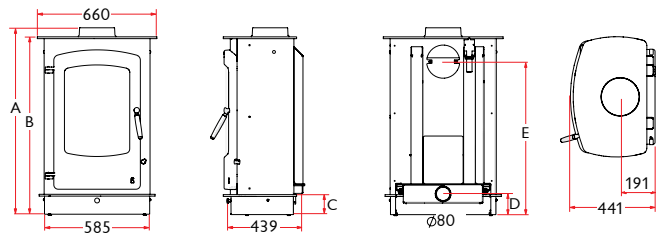

		A	B	C	D	E	WEIGHT
LOW STAND		1030	980	110	115	844	159KG
LOW ARCH STAND		1030	980	110	115	844	159KG
MIDI STAND		1200	1150	280	285	1014	168KG
STORE STAND		1330	1280	410	415	1144	171KG
CENTRE STAND		1330	1280	410	415	1144	187KG

ISLAND III

RATED OUTPUT

11kW to room (range 8-16kW)

NET EFFICIENCY

79%

FLUE OUTLET

Top or Rear **178mm (7")** dia.

MAX LOG LENGTH

611mm (24")

MIN DISTANCE TO COMBUSTIBLES

Side: **600mm** Rear: **600mm** With insulated flue, panels & heat shield - Side: **335mm** Rear: **335mm**

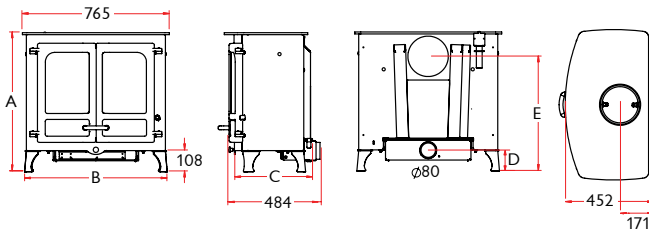

		A	B	C	D	E	WEIGHT
LOW LEGS		713	732	400	107	588	180KG
HIGH LEGS		795	750	400	189	670	184KG
STORE STAND		945	714	309	339	820	197KG



Island III in Almond

BAY VL

RATED OUTPUT

5kW to room (range 2-7kW)

NET EFFICIENCY

81%

FLUE OUTLET

Top only **150mm (6")** dia.

MAX LOG LENGTH

463mm (18")

WEIGHT

94.3KG

MIN DISTANCE TO COMBUSTIBLES

Side: **100mm** Top: **100mm**

See instruction manual for internal casing distances

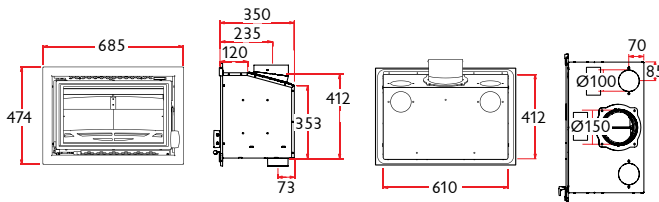

BAY BX

RATED OUTPUT

5kW to room (range 2-7kW)

NET EFFICIENCY

81%

FLUE OUTLET

Top only **150mm (6")** dia.

MAX LOG LENGTH

463mm (18")

MIN DISTANCE TO COMBUSTIBLES

Side: **150mm** Rear: **270mm**

With insulated flue - Side: **100mm** Rear: **130mm**

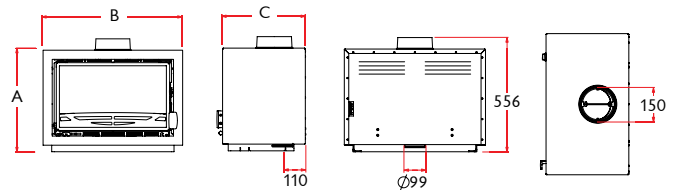

		A	B	C	WEIGHT
FREESTANDING		500	688	403	103KG
STORE STAND		1000	688	500	126KG
CENTRE STAND		910	688	403	136KG
BENCH STAND		1000	1300	500	139KG

C-FOUR / C-FOUR DUO

RATED OUTPUT

4.8kW to room (range 2-5.5kW)

NET EFFICIENCY

82% (C-Four Duo **Wood: 83.5%, Solid Fuel: 78.4%**)

FLUE OUTLET

Top or Rear **125mm (5")** dia.

MAX LOG LENGTH

282mm (11")

MIN DISTANCE TO COMBUSTIBLES

C-Four: Side: **500mm** Rear: **370mm** Insulated flue & heat shield - Side: **500mm** Rear: **175mm**

C-Four Duo: Side: **550mm** Rear: **500mm** Insulated flue & heat shield - Side: **450mm** Rear: **200mm**

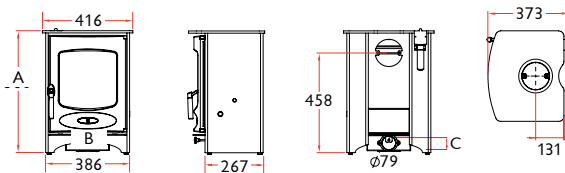

		A	B	C	WEIGHT
LOW LEGS		560	386	45	83KG
STORE STAND		710	386	195	89KG
HIGH LEGS		765	400	247	85.5KG

C-FOUR INSERT

RATED OUTPUT

5.0kW to room (range 2-5.5kW)

NET EFFICIENCY

80% Wood, **77%** Solid Fuel

FLUE OUTLET

Top **125mm (5")** dia.

MAX LOG LENGTH

332mm (13")

MIN DISTANCE TO COMBUSTIBLES

Side: **280mm** Top: **310mm**

See instruction manual for internal casing distances

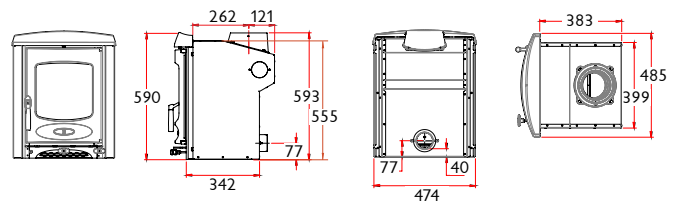

C-FIVE / C-FIVE DUO

RATED OUTPUT

5kW to room (range 2-5.5kW)

NET EFFICIENCY

82% (C-Five Duo **Wood: 84.2%, Solid Fuel: 80.3%**)

FLUE OUTLET

Top or Rear **125mm (5")** dia.

MAX LOG LENGTH

351mm (14")

MIN DISTANCE TO COMBUSTIBLES

C-Five: Side: **500mm** Rear: **400mm** Insulated flue & heat shield - Side: **500mm** Rear: **175mm**

C-Five Duo: Side: **500mm** Rear: **500mm** Insulated flue & heat shield - Side: **500mm** Rear: **300mm**

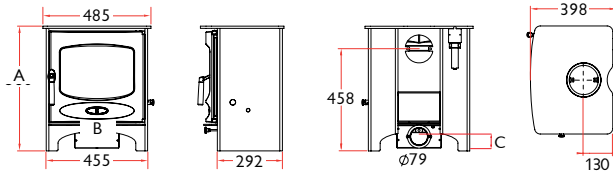

		A	B	C	WEIGHT
LOW LEGS		560	455	65	96KG
STORE STAND		745	455	250	104KG
HIGH LEGS		765	469	271	99.5KG

C-SIX

RATED OUTPUT

5.9kW to room (range 5-7kW)

NET EFFICIENCY

82%

FLUE OUTLET

Top or Rear **150mm (6")** dia.

MAX LOG LENGTH

307mm (12")

MIN DISTANCE TO COMBUSTIBLES

Side: **500mm** Rear: **500mm**

With insulated flue & heat shield - Rear: **200mm**

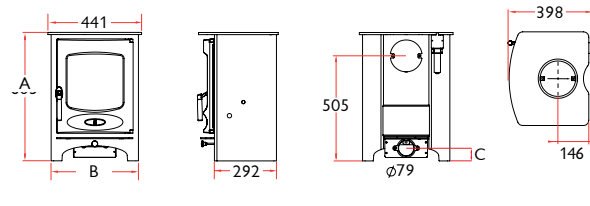

		A	B	C	WEIGHT
LOW LEGS		615	411	63	96KG
STORE STAND		800	411	245	105KG
HIGH LEGS		820	425	265	99.5KG

C-SEVEN

RATED OUTPUT

7.1kW to room (range 6-8kW)

NET EFFICIENCY

79%

FLUE OUTLET

Top or Rear **150mm (6")** dia.

MAX LOG LENGTH

430mm (17")

MIN DISTANCE TO COMBUSTIBLES

Side: **500mm** Rear: **500mm**

With insulated flue & heat shield - Rear: **240mm**

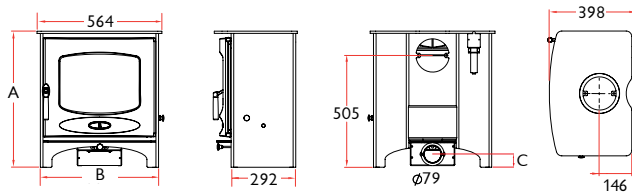

		A	B	C	WEIGHT
LOW LEGS		615	534	59	115KG
STORE STAND		800	534	244	124KG
HIGH LEGS		820	548	269	118.5KG

C-EIGHT

RATED OUTPUT

8kW to room (range 7-9kW)

NET EFFICIENCY

81%

FLUE OUTLET

Top or Rear **150mm (6")** dia.

MAX LOG LENGTH

366mm (14")

MIN DISTANCE TO COMBUSTIBLES

Side: **600mm** Rear: **650mm**

With insulated flue & heat shield - Side: **550mm** Rear: **250mm**

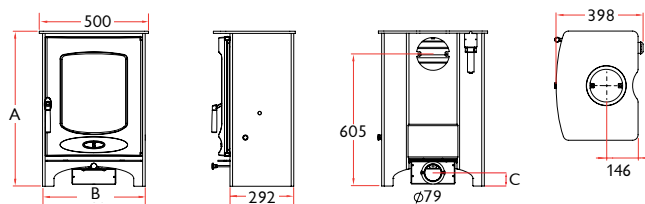

		A	B	C	WEIGHT
LOW LEGS		710	465	61	119KG
STORE STAND		895	470	246	127KG
HIGH LEGS		915	484	268	122.5KG

SKYE 5

RATED OUTPUT

5kW to room (range 2-7kW)

NET EFFICIENCY

86% Wood, 82% Solid Fuel

FLUE OUTLET

Top or Rear **125mm (5")** dia.

MAX LOG LENGTH

350mm (13.5")

WEIGHT

135KG Low, **155KG** Store Stand

MIN DISTANCE TO COMBUSTIBLES

Side: **300mm** Rear: **270mm** With insulated flue & heat shield - Side: **200mm** Rear: **90mm**

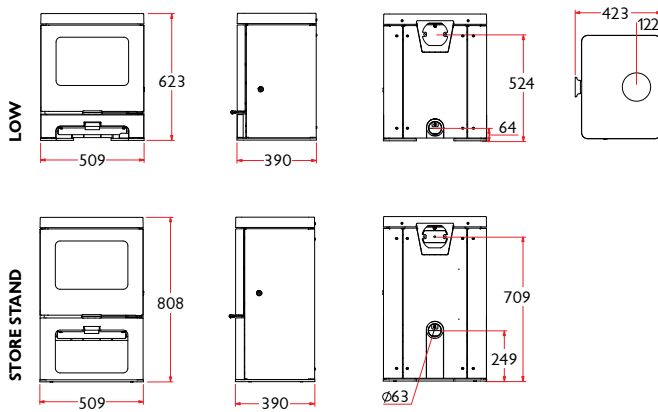

SKYE 7

RATED OUTPUT

7kW to room (range 5-11kW)

NET EFFICIENCY

80% Wood, 81% Solid Fuel

FLUE OUTLET

Top or Rear **150mm (6")** dia.

MAX LOG LENGTH

410mm (16")

WEIGHT

157KG Low, **177KG** Store Stand

MIN DISTANCE TO COMBUSTIBLES

Side: **350mm** Rear: **350mm** With insulated flue & heat shield - Side: **350mm** Rear: **100mm**

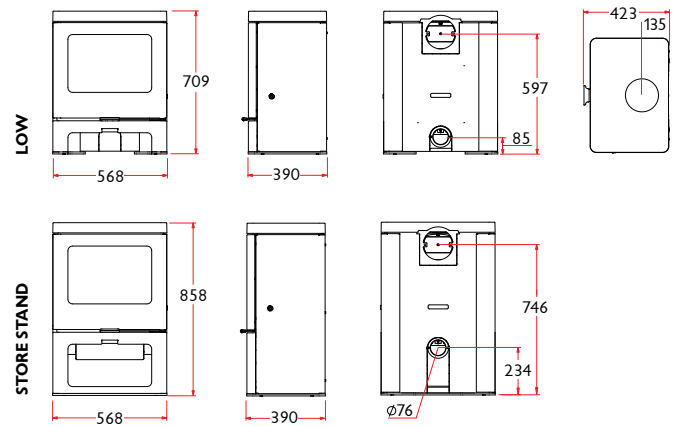

SKYE E700



RATED OUTPUT

7.4kW to room (range 5-11kW)

NET EFFICIENCY

89%

FLUE OUTLET

Top or Rear **150mm (6")** dia.

MAX LOG LENGTH

406mm (16")

WEIGHT

145KG Low, **165KG** Store Stand

MIN DISTANCE TO COMBUSTIBLES

Side: **300mm** Rear: **250mm** With insulated flue & heat shield - Side: **300mm** Rear: **100mm**

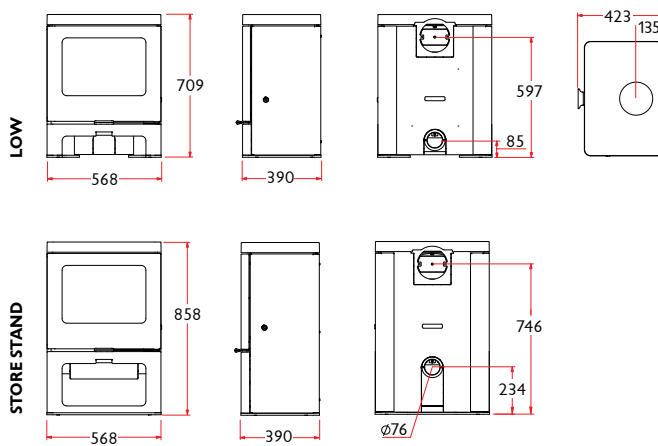

HAVEN

RATED OUTPUT

6.6kW to room (range 5-7kW)

NET EFFICIENCY

90%

FLUE OUTLET

Top or Rear **125mm (5")** dia.

MAX LOG LENGTH

200mm (8")

WEIGHT

152KG High Leg, **165KG** Store Stand

MIN DISTANCE TO COMBUSTIBLES

Side: **500mm** Rear: **400mm** Top: **750mm**

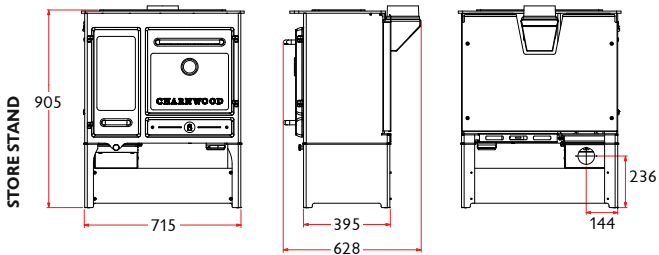
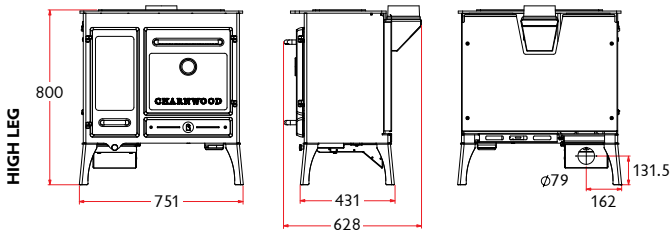
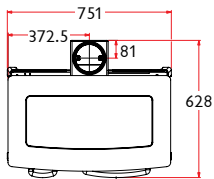

THE BEMBRIDGE

RATED OUTPUT

5kW to room (range 2-5.5kW)

NET EFFICIENCY

82%

FLUE OUTLET

Top or Rear **125mm (5")** dia.

MAX LOG LENGTH

351mm (14")

MIN DISTANCE TO COMBUSTIBLES

Side: **500mm** Rear: **400mm**

With insulated flue & heat shield - Rear: **175mm**

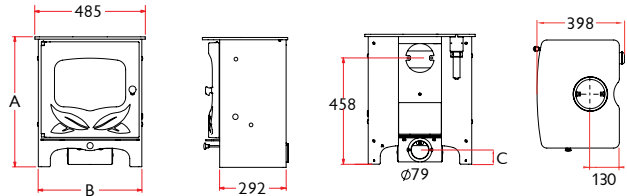

		A	B	C	WEIGHT
LOW LEGS		560	455	65	80KG
STORE STAND		745	455	250	89KG
HIGH LEGS		765	469	268	83.5KG

STOVE POD

The Stove Pod is compatible with the Aire 3 and Cranmore 3 only.

WEIGHT (EXC. STOVE)

38KG Powdercoat, **47KG** Enamel Liner

MIN DISTANCE TO COMBUSTIBLES

Rear: **50mm**

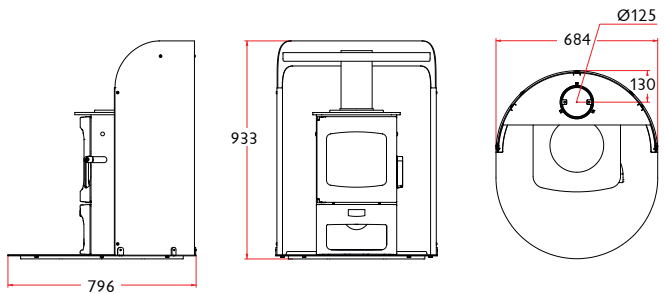

COUNTRY 4

RATED OUTPUT

5kW to room (range 2-5.5kW)

NET EFFICIENCY

84%

FLUE OUTLET

Top or Rear **125mm (5")** dia.

MAX LOG LENGTH

332mm (13")

WEIGHT

60kg

MIN DISTANCE TO COMBUSTIBLES

Side: **480mm** Rear: **550mm**

With insulated flue & heat shield - Rear: **150mm**

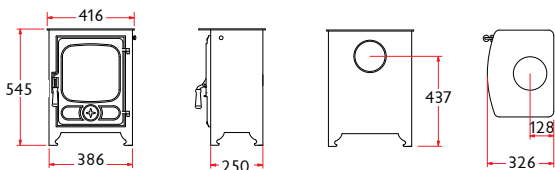

A collection of woven baskets and a strainer are arranged on a log fire. The baskets are made of light-colored, textured material, possibly straw or reeds, and feature various weaving patterns. One basket is tall and cylindrical, another is shorter and wider, and a third is a shallow, wide bowl. A long, curved strainer with a dark handle is also visible. The background consists of dark, charred logs with patches of green moss, creating a rustic, outdoor setting.

FIRESIDE ACCESSORIES

COOKING, GIFT IDEAS AND FAIR TRADE FIRESIDE



charnwood ACCESSORIES

Charnwood offer a wide range of accessories designed to optimise the performance of your stove and enhance your fireside experience.

MOISTURE METER

Your Charnwood stove is designed to run on seasoned or kiln dried wood. It is very important that the logs you burn have a moisture content of less than 20%.

Use a Charnwood Moisture Meter to check logs are dry and properly seasoned before burning. Insert the prongs into the grain of the wood to determine its moisture content.



ASH-CARRIER



For clean, safe and effective disposal of ash, an optional ash-carrier is available for all our Haven, Cranmore, Aire, Skye, Arc, Cove, Island, C-Series, Bembridge, Country 4 models.

STOVE PIPE THERMOMETER

A simple device that attaches to the flue pipe to show the rate at which your stove is burning. This allows you to adjust the fire accordingly so you don't damage your stove by over or underfiring.



TOASTING FORK

The Charnwood Toasting Fork is a neat, highly effective stove accessory designed for use on all freestanding stove models.

Simply place the magnetic holder onto the stove top and suspend the fork in front of the glass for perfectly toasted bread, muffins or crumpets. The fork and holder is British made from stainless steel with a turned beech handle.



CHARNWOOD FIRE BALL

The Charnwood Fire Ball is a simple yet effective outdoor fire bowl. This iconic piece is cut from mild steel and supplied as a boxed flat pack kit. We recommend placing the fireball on a non-combustible base such as a concrete paving slab. The Fire Ball will naturally oxidise over time. Designed for outdoor use.





PLEASE NOTE: The stove installations photographed within this brochure are intended as a guide only - Installation must be carried out by a competent engineer in accordance with Building Regulations and local by-laws. Full details are shown in the Installation and Operating Instructions which are available on request. Charnwood's policy is one of continuous development and we reserve the right to change sizes and specifications without notice. All Charnwood stoves are independently certified to conform to EN16510. All Haven, Cranmore, Aire (excluding Aire on low stand), Skye, Arc, Cove, Island, C-Series (excluding C-Five Duo on low stand) and Bembridge stoves meet the UK building requirements for installation with a 12mm non-combustible hearth.

BODJ FAIR TRADE FIRESIDE

Bodj is a fair trade programme exclusive to Charnwood stoves. The initiative sells a selection of fireside accessories manufactured by a number of small developing businesses in Cambodia, South East Asia. We currently work alongside and support three projects each producing unique products using traditional techniques and from ecologically and locally sourced materials. Our aim is to make a difference to these communities: to actively encourage and celebrate their cultural skills whilst ensuring fair wages and responsible trading practices.

BASKETWARE PROJECT

The Bodj basketware initiative supports a number of basket weaving projects on the outskirts of Phnom Penh and in the Cambodian province of Kratie. A mixture of indigenous materials are used from bamboo and rattan to rush and water hyacinth. Age old weaving techniques are used to create a variety of traditional and adapted designs including log baskets and brushes.

IRONWORK PROJECT

Bodj ironwork products are made by an ironworking initiative based in Phnom Penh. The project trains up a number of young people from disadvantaged backgrounds. Traditional skills are mixed with Khmer inspired designs to create a variety of log holders, companion sets and tools.

RECYCLING PROJECT

The Bodj recycled products are produced by a project based in the Kompong Thom province of Cambodia. Colourful rice sacks are recycled into unstructured log and kindling buckets.

All the Bodj projects are kept deliberately small-scale with working practices within the communities carefully monitored so as not to disturb the eco-system in which the craftspeople live. The production processes of many of the products are also dictated by monsoons therefore availability is sometimes limited. For more information on the full range of products and projects speak to your local stockist or visit bodj.co.uk



Grateful thanks to all who have contributed to this brochure • God, The Pig Hotel, Elizabeth & Michael at Padmore House, Mark Lazenby, Rachel Ashwell, Emma Paton, Patricia Rodi, Reuben Mowle, Ben Cooke & The Little Gloster, Prussia Cove, Charlie & Josie Irons, Lily Pebbles, Ventnor Botanic Garden, Paper Mill Studios, Helen & Frazer Cunningham, Bayliss & Booth, Marie, Lincoln & Lisa, Mini Moderns, Margie, Steve Thearle, Pheobe, Rona, Toast, Cambodian crew, Tanya Goodwin, Sam Twining, Jemma, Sarita & Dominic Blackmore, Gillie & Nigel, Holly Joliffe, Jo Samways, Jimmy Mower, Charles Clarke, Dave & Atlanta at Beach Studios, Chris Jackson, Moor Farm, Country Living Magazine • Art direction and design by Charnwood.



Opposite left top: Fat lip basket, log hoop, small floppy basket, large floppy basket, lotus log holder and wall mounted companion set

Opposite left bottom: Standard bamboo basket, floor standing companion set, angkor basket, blow poker, g-holder and recycled rice sack bucket

Above clockwise: Lotus log holder, floor standing companion set, small floppy basket, fat lip basket



charnwood

Bishops Way, Newport, Isle of Wight, PO30 5WS, United Kingdom • Tel. +44 (0) 1983 537777 • www.charnwood.com

