

**stûv** *P-10*

---

A new view on fire

P-10

**Stûv P-10**

Combining the  
flame picture  
with pellet  
efficiency

**[stuv.com](http://stuv.com)**

## **Stûv, the essential fire**

Stûv products are designed and manufactured to bring warmth and wellbeing into your home. Stûv design strives to combine looks and practicality into pure lines and robust technology. Applying design to improve what fire offers by its nature, to bring boosted performance and an enhanced experience. It's about innovating until we find harmony with the environment. An efficient and natural heating solution as an essential part of your home.

At the heart of your home, Stûv creates the hearth.

# Face-to-face with fire







# Personalised finishes for a unique product



With its elegant design and advanced heat technology, the Stûv P-10 is integrated into the heart of your living space. Stûv P-10 means making the most of an efficient, pleasant and controlled heat. Relax in front of the dancing flames, thanks to the patented technology which brings calm and fullness to the flame from wood pellets. Make the most of the diffusion of this natural heat, silent and controlled. The Stûv P-10 is a wood pellet stove that is one of a kind, combining looks, function and authenticity.

**The Stûv P-10 is available in several different finishes:**

- + Curved base in Stûvgrey or Stûvblack steel (see above)
- + Rectangular base in dark or bleached oak (see opposite)
- + Rectangular base which you can customise with the finishing material of your choice

# Spotlight on heat

- + Pellet stove giving a broad, full flame
- + Upper section features lots of glass and can be rotated
- + Operates silently
- + Lower section clad in steel, wood or even in a bespoke material
- + Remote control via a thermostat or smartphone/tablet



Stûv P-10 with wooden base, dark oak





### Stûv P-10

The top part of the stove rotates to direct radiant heat and offer the best view of the fire through the large window.



# Patented technology for a sculpted flame



- + Patented technology to shape the flame
- + Highly efficient combustion, super-low waste
- + Natural convection adjustable between 2,4 and 8 kW  
(see technical specifications)
- + Radiation through the large window

Stüy P-10 with wooden base, bleached oak

# Enjoy the silence

- + Wood pellets are lifted, no annoying clattering
- + Natural convection - no noise from the blower
- + 35 to 40 dBA (equivalent to the sound environment of a library)



# Practical and ergonomic

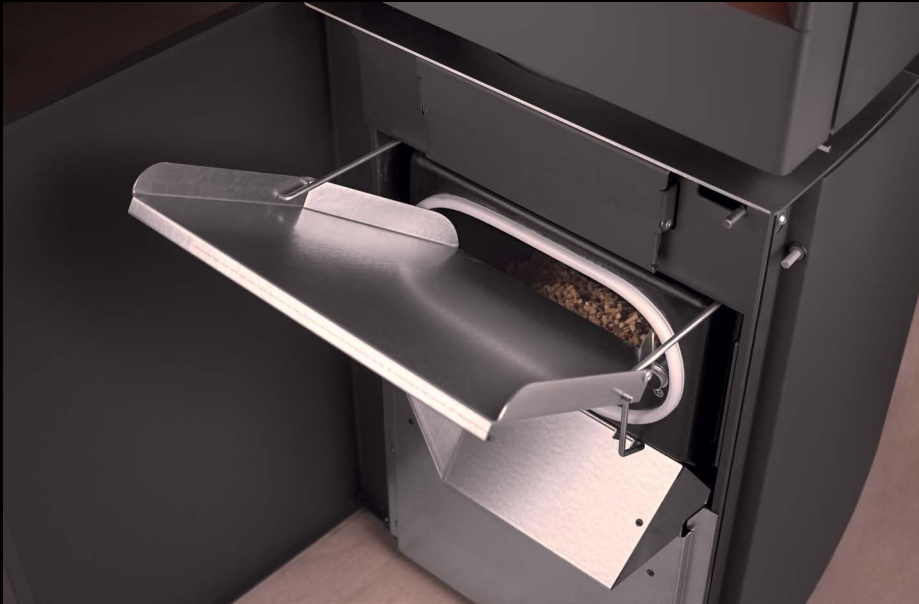

## **Loading door**

The loading door lets you load the pellets at hip height. The 16kg hopper capacity offers 10 hours of heating at maximum power or 30 hours at minimum power.



## **Cleaning system and ash pan**

The manual cleaning system means you can clean the burner and have the ash fall into the ash pan. The ash pan should be emptied once every 150 hours of operation.

# A smart pellet stove

A user-friendly interface developed for the remote control and mobile app



## Remote control

- + Backlit touchscreen
- + Integrated thermostat



## Smartphone and tablet app

- + Available as standard
- + Lets you control the device when you're at home (WiFi) and remotely (4G)
- + WiFi required in the home

## Stûv P-10 – Performance that's ahead of its time

In a classic pellet stove, cleaning the burner during the combustion cycle reduces efficiency approximately once an hour. Removing the ash clogs up the flue and increases pollution. With the Stûv P-10, the burner does not need to be cleaned while the stove is operating. Ash is removed manually when the stove is not operating. This guarantees maximum efficiency at all times, with almost zero pollution.

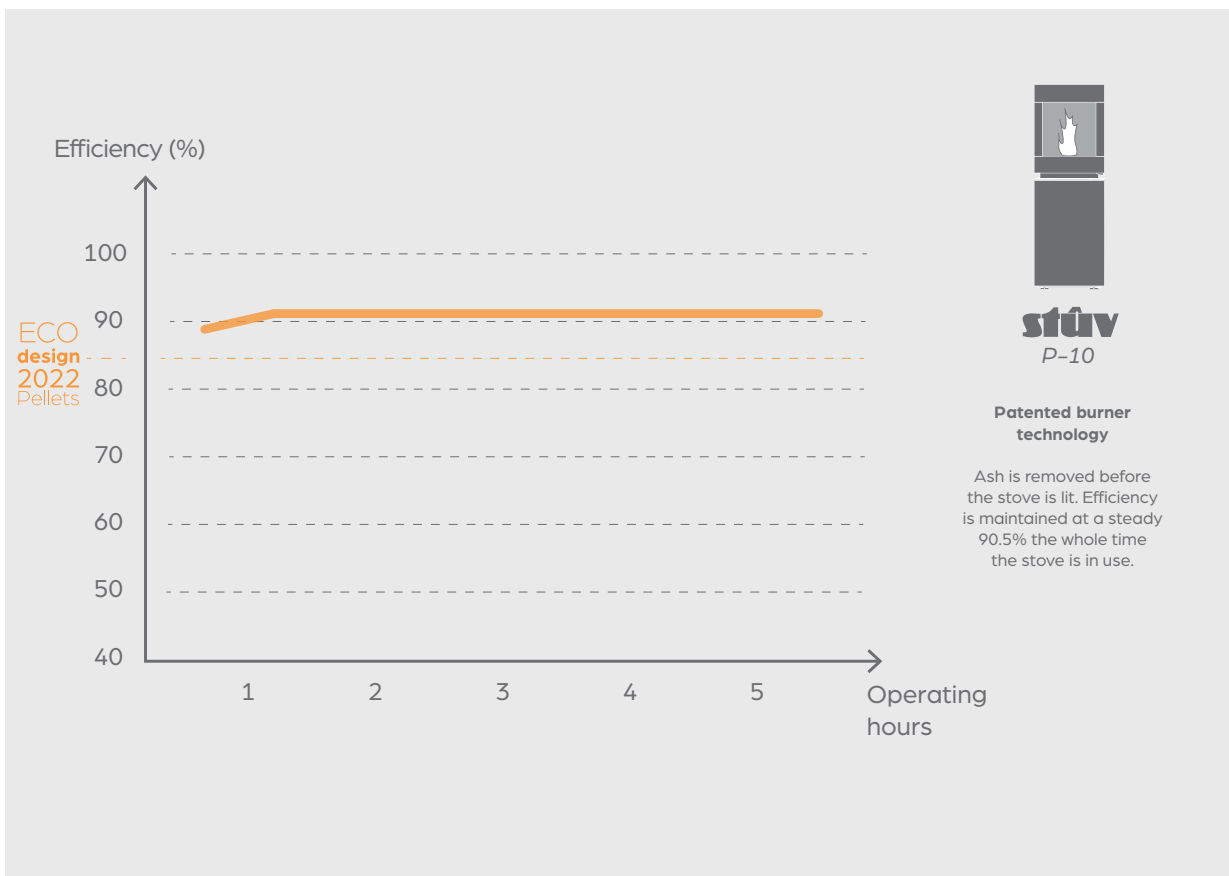
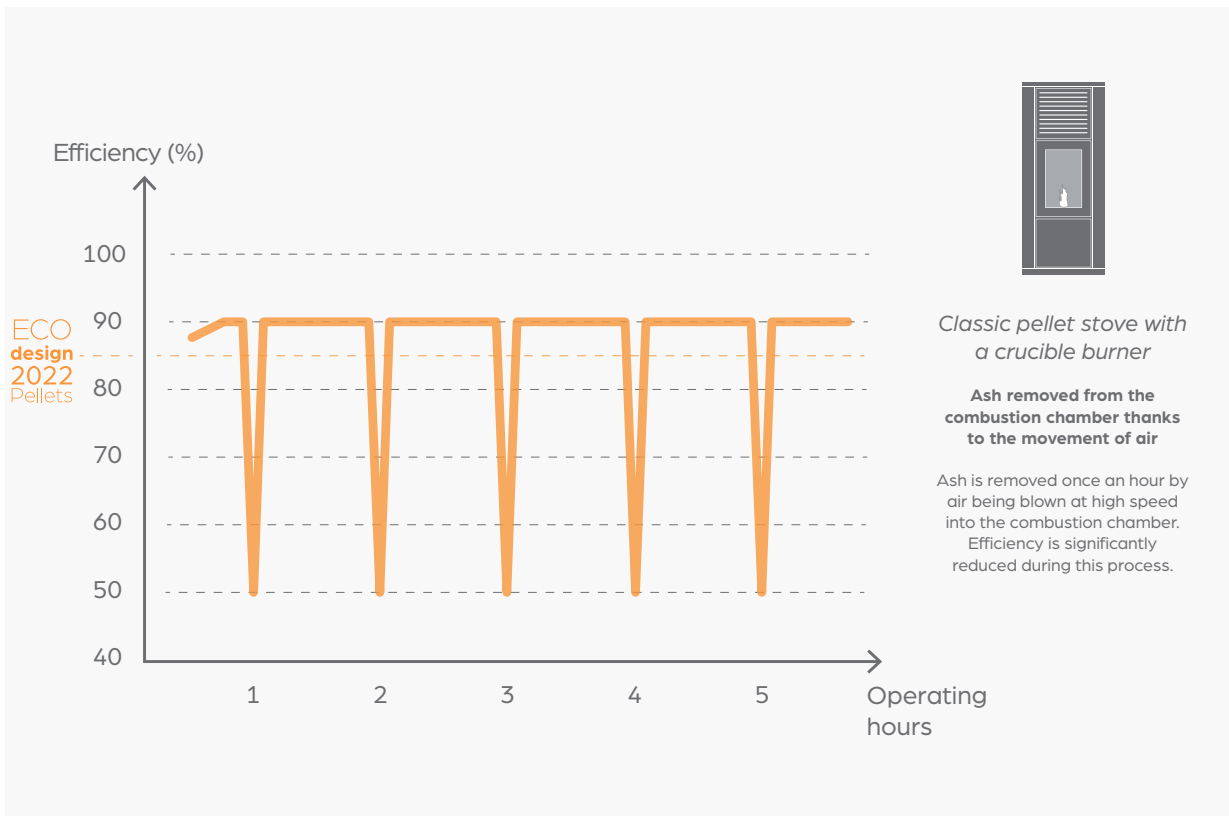

With its high level of efficiency and incredibly low fine particle emissions, the Stûv P-10 performs better than the requirements stipulated by the Ecodesign standard for 2022. The Stûv P-10 pellet stove issues almost 1000 fewer fine particles than an open fire. The fine particle and CO emissions from the Stûv P-10 are so low that official tests carried out by specialist independent laboratories barely detect them. With 90% efficiency!

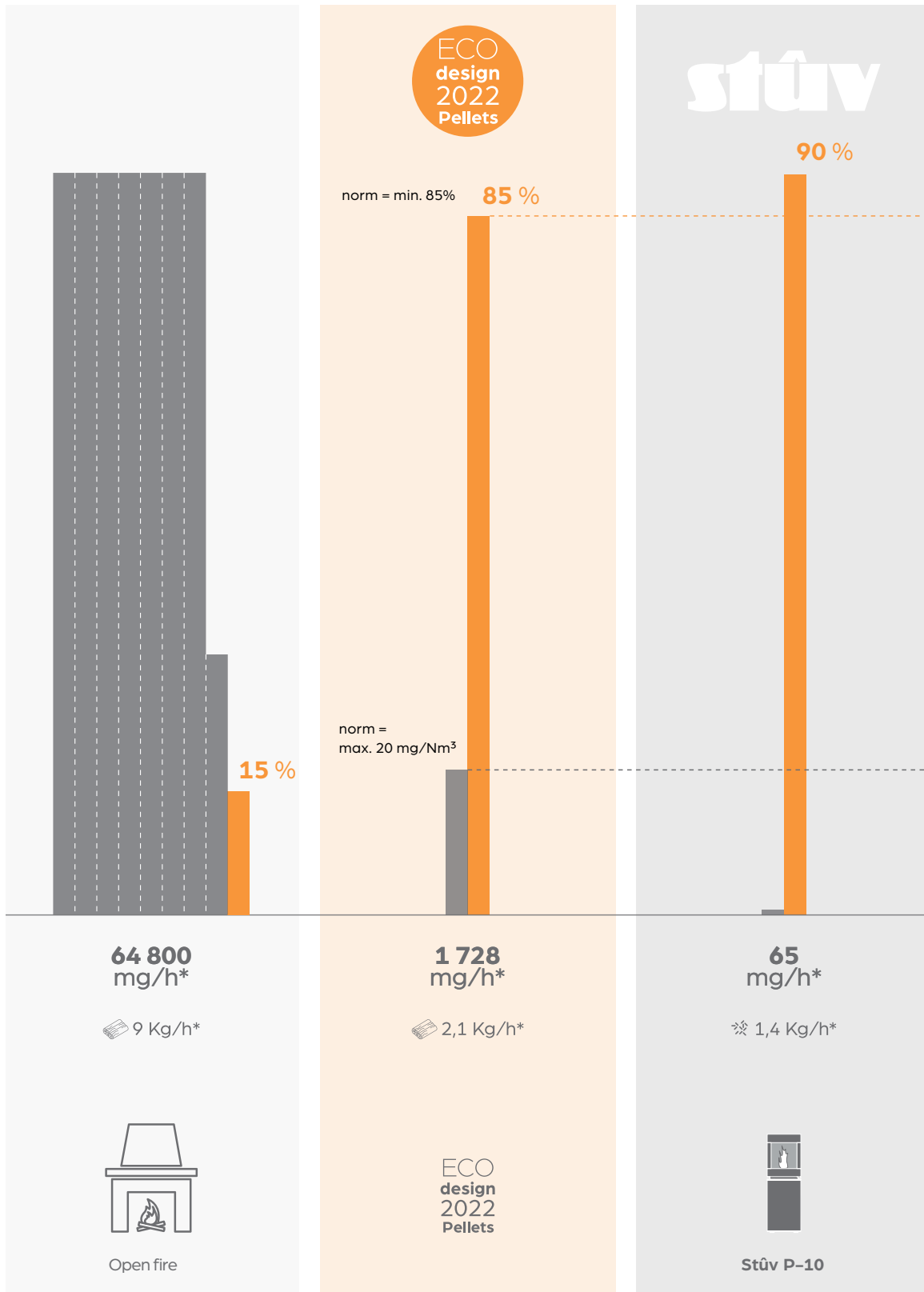

■ particle emissions

■ efficiency

\* to an output of 6 kW

## Combustion and convection

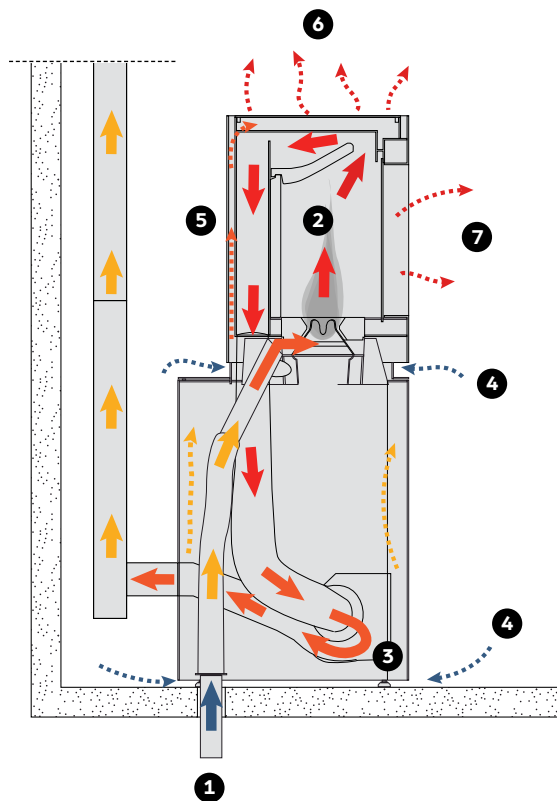

## Journey of the pellets

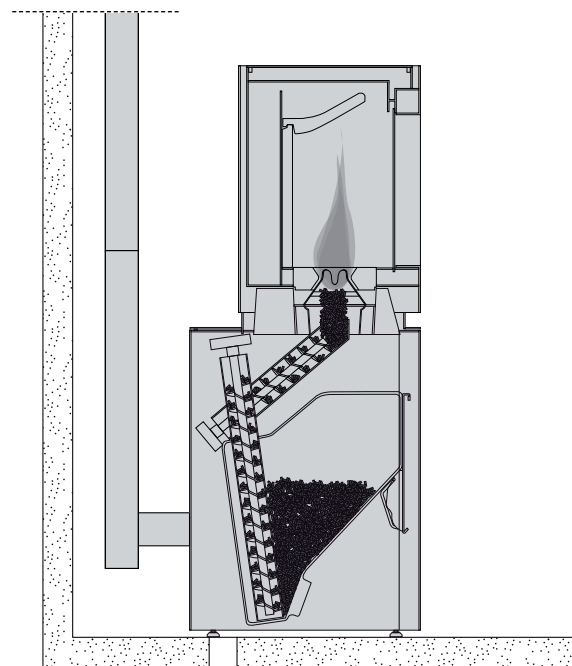

- 1** The air needed for combustion is taken from outside the building. (Under the stove or at the back of the device) or from inside the building.
- 2** The air inlet, the combustion chamber and the smoke extraction form an airtight system that does not interfere with the building's insulation or ventilation.
- 3** The smoke passes through a heat exchanger, is drawn in by an extractor and is then removed via the chimney flue.
- 4** The air is drawn into the living area and reheated
- 5** The air moves around the convection chamber and collects the heat from the smoke.
- 6** The reheated air comes out of the device naturally, then noiselessly spreads around the room.
- 7** The heat radiates through the glass.



# Stûv P-10

## Technical data



### Technical specifications

	P-10
weight of unit   kg	175
nominal output   kW	8
optimum output range   kW	2,4 - 8 *
efficiency   %	> 90
CO emissions   %	0,001
particle emissions   mg/Nm <sup>3</sup>	<20
energy efficiency index (EEI)	130
energy efficiency class	A++
hopper capacity   kg	16
heating time (min/max)   h	30 (2,4kW) - 10 (8kW)
pellet consumption rate   kg/u	0,6 (2,4kW) - 1,8 (8kW)
outside air intake   ø - mm	60
electrical consumption   W	40
decibels	de 35 à 40 dBA **

### Features

	P-10
+ pivoting top part (manual)	standard
+ ash removal system (manual)	standard
+ removable ash pan	standard
+ remote control with touchscreen and integrated thermostat	standard
+ can be controlled via a mobile app (WiFi)	standard

### Patents

	P-10
EP 2304319, JP 5390603	
US 8.904.944, US 8.826.899	

\* Minimum power P1 (2.4kW) or P5 (3.7kW) depending on installation restrictions

\*\* Equivalent to the sound environment of a library

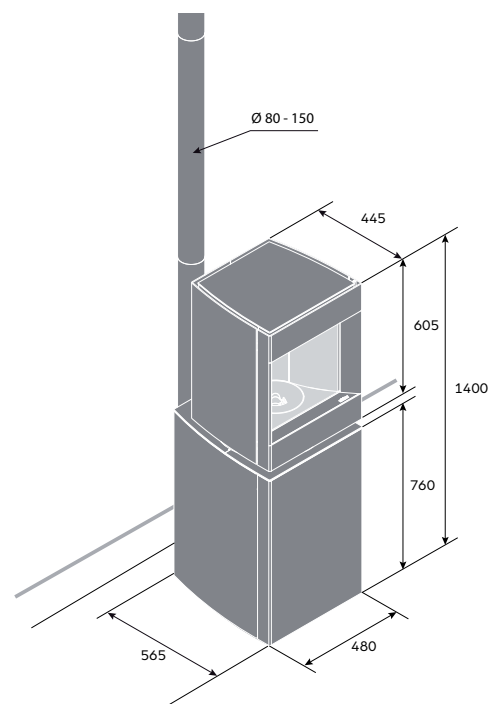

Stûv P-10 with steel base

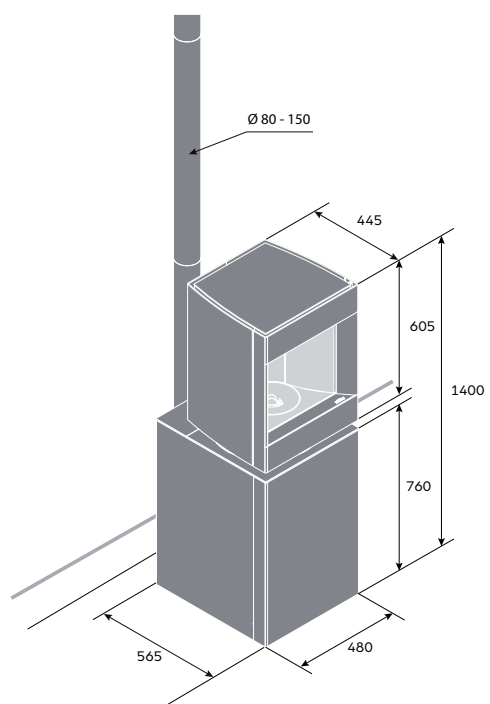

Stûv P-10 with wooden/  
trimmable base

## Constantly striving for improvement...

Stûv invests heavily in research and development both in its own laboratory and thanks to partnerships with experts in the field of combustion. Every detail is important to optimise how a fire works. Stuv products meet the highest standards when it comes to respecting the environment.

All fires comply with: EN 14785 CE, Paris PPA (FR), BimSchV2 (DE), 15A (AT), EcoDesign Pellets 2022 (EU).



reddot design award  
winner 2016

### The Stûv guarantee

- + The fires and their components are manufactured in Belgium, in the heart of Europe, with the greatest care. A well-maintained Stûv fire will last a lifetime.
- + Stûv offers users of its products an extended warranty: a total of 3 years for the body of the fire, 2 years for the electrical components and 3 years for the other components (see terms and conditions at [stuv.com](http://stuv.com)).
- + Fill in the online form at [stuv.com](http://stuv.com) to benefit from this extended warranty.



## Colophon

design Brigitte Boits

photography François Chevalier

styling Edith Vervest

communication manager Serge Alhadeff

responsible editor Gérard Pitance

Documents and photos are for information purposes only. Stûv reserves the right to make changes without warning. Every care has been taken in the preparation of this brochure; however, we do not accept any responsibility for any mistakes that it may contain.



# Find out about all the products in the Stûv range

+ wood

**Stûv 6 | Stûv 16 | Stûv 21 | Stûv 22 |**

**Stûv 30 | Stûv 30-compact |**

**Stûv microMega**

+ pellets

**Stûv P-10**

Stûv stoves are distributed by :



Stûv stoves are designed and  
manufactured by: **Stûv nv**  
rue Jules Borbouse 4  
B - 5170 Bois - de - Villers  
Belgium  
info@stuv.com  
**stuv.com**

Join us



**stûv**  
The essential fire